

Rio Del Mar Elementary School

819 Pinehurst Drive, Aptos, CA 95003

Aerial Photo Taken 3/8/06

SCHOOL MAP

Rio del Mar Elementary 2010- 2011

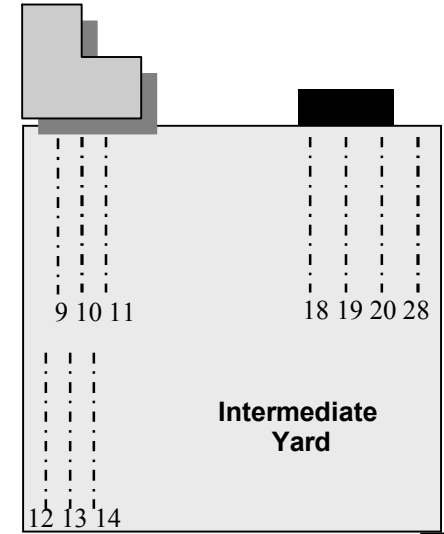
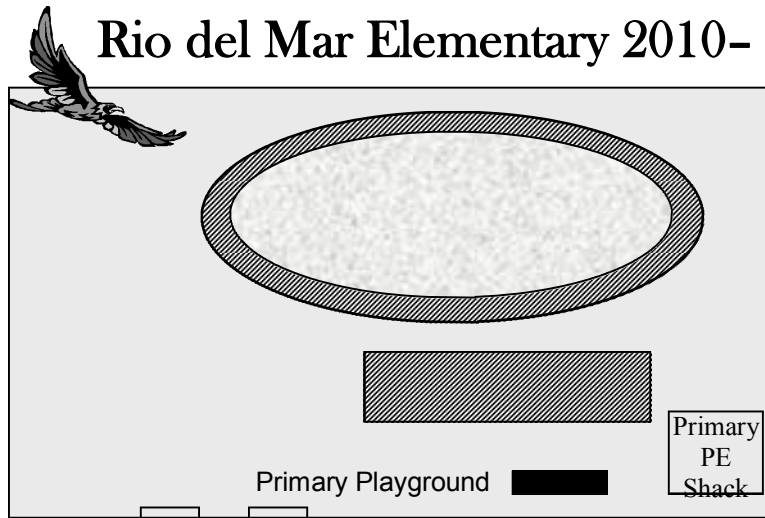

R.S.P

| |
|--------------------|
| 26 |
| 25 Lee |
| 24 Mayer 3rd |

21
Maraldo
3rd

22
Terribilini
3rd

23
Mitchener
Land

27
Storage

Tools
Wrenches

Gas
Shut OFF

819 Pinchurst Dr
Aptos Ca 95003
688-2053

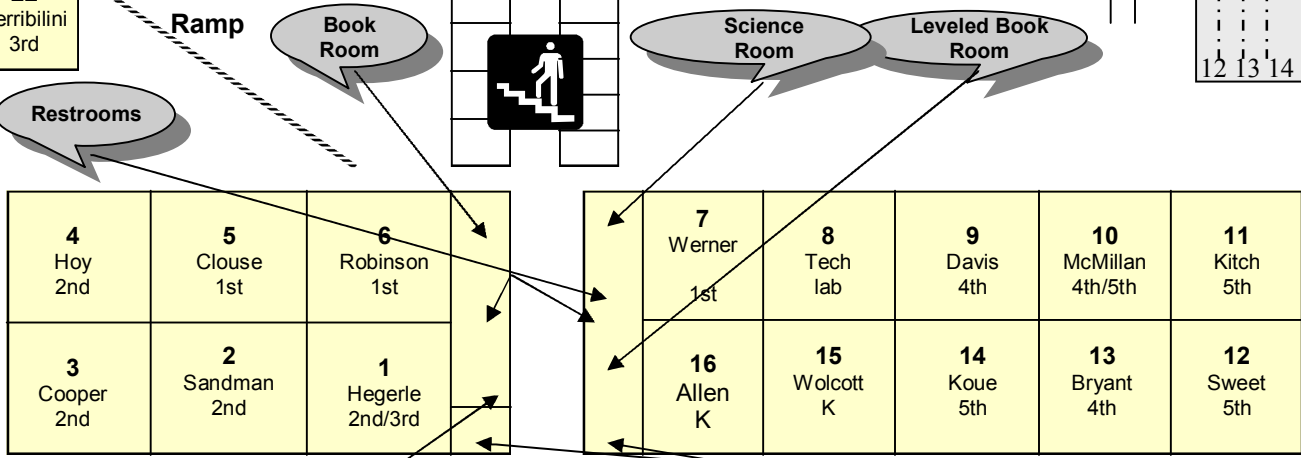

20
McNeilly
Salazar

19
Zepeda
6th

28
Casey
SED

PE

18
Kyle
6th

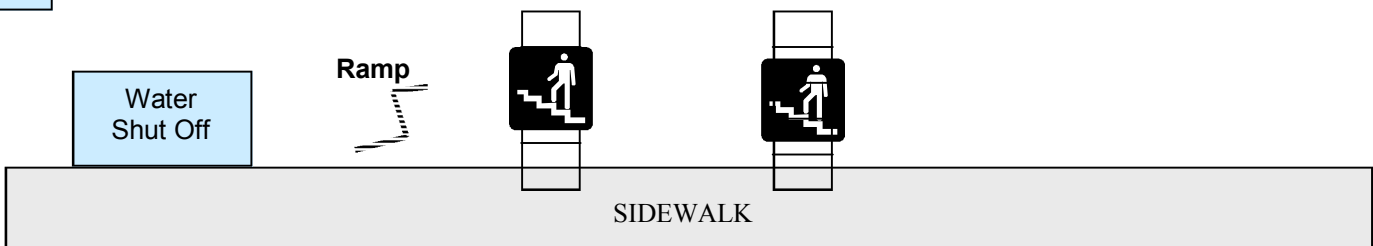
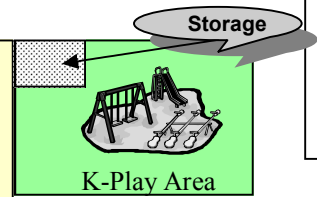
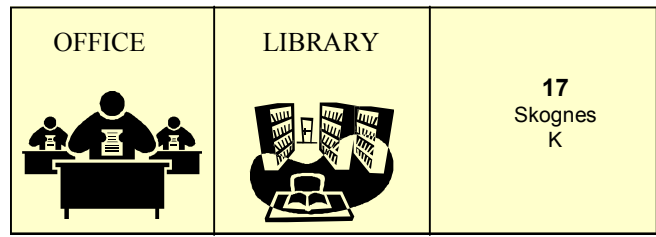
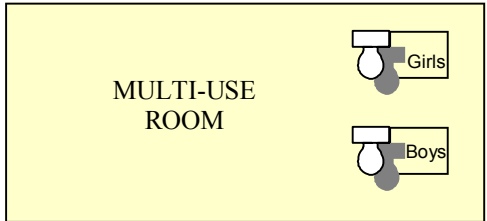

SCHOOL MAP EVACUATION PLAN

Rio del Mar Elementary 2010- 2011

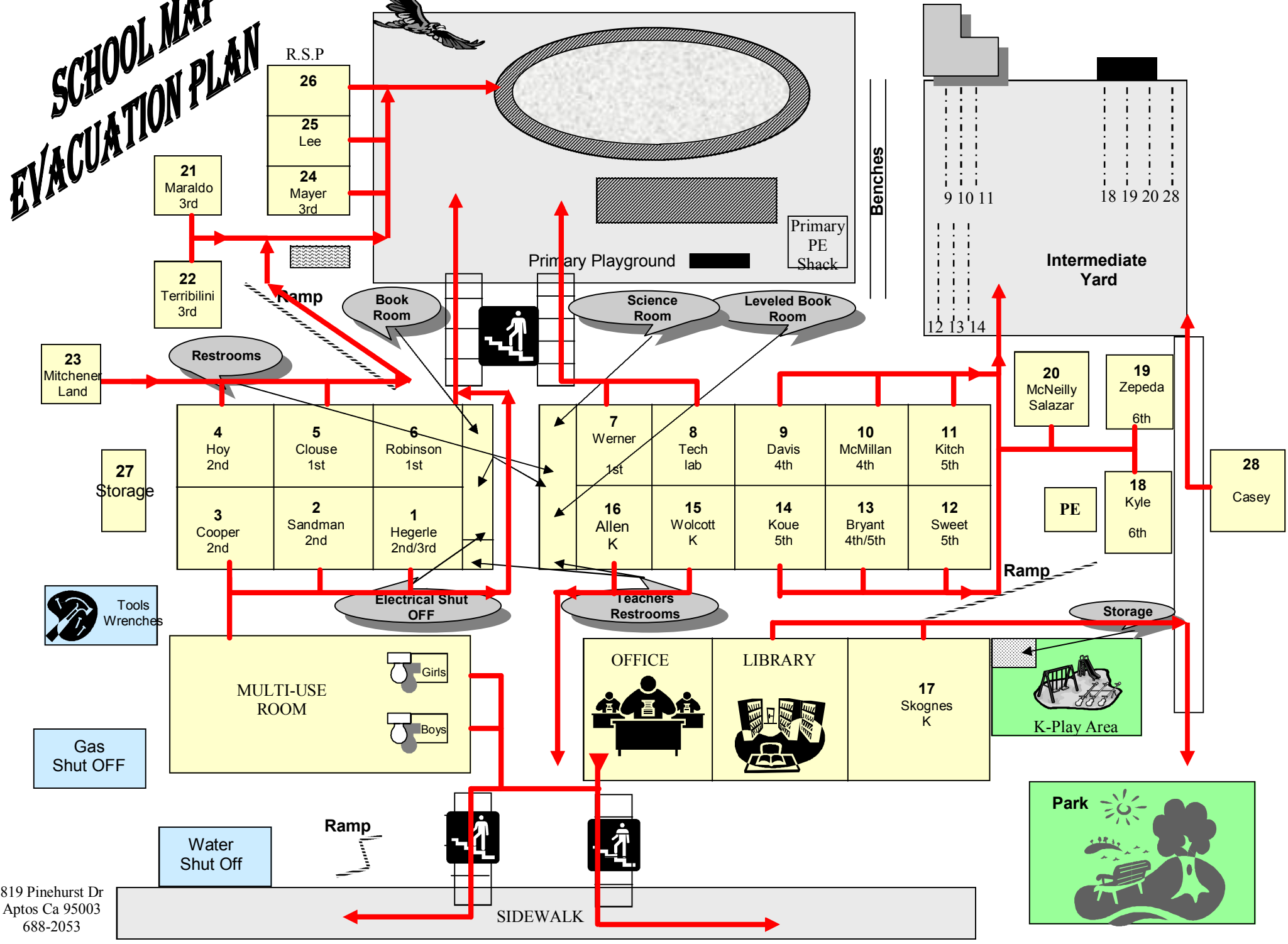

819 Pinehurst Dr
Aptos Ca 95003
688-2053

Rio Del Mar Elementary School K-6

819 Pinehurst Drive, Aptos, CA 95003

Phone: (831) 688-2053 Fax: (831) 728-6467

053-011-12

10.0 Total Usable Acreage - 4.5 Total Unusable Acreage

Updated 3/2011

Gross Sq. Ft. Site Use Summary

| | | | | | |
|--------------|----------------------------|----------------|---------------|----|------------|
| Permanent | Classrooms | sq. ft. | 17,465 | 18 | rooms |
| Relocatables | Classrooms | sq. ft. | 9,120 | 10 | rooms |
| Permanent | Staff Area | sq. ft. | 1,311 | 6 | rooms |
| Permanent | Library | sq. ft. | 1,194 | 1 | rooms |
| Permanent | Restrooms-Staff | sq. ft. | 264 | 5 | rooms |
| Permanent | Restrooms-Student | sq. ft. | 609 | 4 | rooms |
| Permanent | Multi-Purpose Room | sq. ft. | 3,201 | 1 | rooms |
| Permanent | Kitchen | sq. ft. | 528 | 1 | rooms |
| Permanent | Mechanical/Custodial Rooms | sq. ft. | 970 | 7 | rooms |
| Permanent | Storage | sq. ft. | 1,120 | 6 | rooms |
| Relocatables | Storage | sq. ft. | 840 | 1 | rooms |
| Permanent | A.C. Play Area | 31,230 | sq. ft. | | |
| Permanent | A.C. Parking Area | 53,773 | sq. ft. | 49 | spaces |
| Permanent | A.C. Bus Lane Areas | 13,770 | sq. ft. | | |
| Permanent | Play Box Structure | 3,307 | sq. ft. | 19 | structures |
| Permanent | Sand Box | 14,406 | sq. ft. | | |
| Permanent | Covered Corridor/Walkways | 5,167 | sq. ft. | | |
| Permanent | Roof Area | 27,268 | sq. ft. | | |
| Relocatables | Roof Area | 11,682 | sq. ft. | | |
| Permanent | Total Teaching Stations | | | 28 | rooms |
| Permanent | Computer Labs | | | 1 | rooms |
| | Science Lab(s) | | | 0 | rooms |
| | TOTAL Building | sq. ft. | 36,622 | | |
| | | | | | |

WING "A"

Administration wing built in 1967, D.S.A. No. 28691

| | | | | | |
|-----------|---------------------------|----------------|--------------|---|-------|
| Permanent | Classrooms | sq. ft. | 1,605 | 2 | rooms |
| Permanent | Staff Room/Office Area | sq. ft. | 1,311 | 6 | rooms |
| Permanent | Restrooms- Staff | sq. ft. | 51 | 1 | rooms |
| Permanent | Restrooms- Boys/Girls | sq. ft. | 45 | 1 | rooms |
| Permanent | Library | sq. ft. | 1,194 | 1 | rooms |
| Permanent | Mechanical/Custodial Room | sq. ft. | 49 | 1 | rooms |
| Permanent | Storage | sq. ft. | 166 | 4 | rooms |
| Permanent | Open Corridor/ Walkways | 900 | sq. ft. | | |
| Permanent | Roof Area | 4,500 | sq. ft. | | |
| | | | | | |
| | TOTAL Building | sq. ft. | 4,421 | | |
| | | | | | |

WING "B"

Classroom 7-16 built in 1962, D.S.A. No. 23119

| | | | | | |
|-----------|---------------------------|----------------|---------------|----|-------|
| Permanent | Classrooms | sq. ft. | 9,864 | 10 | rooms |
| Permanent | Restroom- Staff | sq. ft. | 49 | 1 | rooms |
| Permanent | Restroom- Boys | sq. ft. | 152 | 1 | rooms |
| Permanent | Restroom- Girls | sq. ft. | 152 | 1 | rooms |
| Permanent | Mechanical/Custodial Room | sq. ft. | 458 | 1 | rooms |
| Permanent | Cover Corridor/Walkways | 1,214 | sq. ft. | | |
| Permanent | Roof Area | 11,300 | sq. ft. | | |
| | | | | | |
| | TOTAL Building | sq. ft. | 10,675 | | |
| | | | | | |

WING "C"

Classroom 1-6 built in 1962, D.S.A. No. 23119

| | | | | | |
|-----------|----------------------------|----------------|--------------|---|-------|
| Permanent | Classroom | sq. ft. | 5,996 | 6 | rooms |
| Permanent | Restrooms- Staff | sq. ft. | 49 | 1 | rooms |
| Permanent | Restrooms- Boys | sq. ft. | 147 | 1 | rooms |
| Permanent | Restrooms- Girls | sq. ft. | 158 | 1 | rooms |
| Permanent | Mechanical/Custodial Room | sq. ft. | 255 | 1 | rooms |
| Permanent | Covered Corridors/Walkways | 1,214 | sq. ft. | | |
| Permanent | Roof Area | 7,300 | sq. ft. | | |
| | | | | | |
| | TOTAL Building | sq. ft. | 6,605 | | |
| | | | | | |

WING "D"

Multi-Purpose Room built in 1965, D.S.A. No. 26201

| | | | | | |
|-----------|----------------------------|----------------|--------------|---|-------|
| Permanent | Multi-Purpose Room | sq. ft. | 3,201 | 1 | rooms |
| Permanent | Kitchen | sq. ft. | 528 | 1 | rooms |
| Permanent | Restrooms- Men | sq. ft. | 61 | 1 | rooms |
| Permanent | Restrooms- Women | sq. ft. | 52 | 1 | rooms |
| Permanent | Closet & Lockers | sq. ft. | 49 | 2 | rooms |
| Permanent | Mechanical/Custodial Room | sq. ft. | 209 | 2 | rooms |
| Permanent | Covered Corridors/Walkways | 1,109 | sq. ft. | | |
| Permanent | Roof Area | 4,168 | sq. ft. | | |
| | | | | | |
| | TOTAL Building | sq. ft. | 4,100 | | |
| | | | | | |

Restroom Facility Counts for Rio Del Mar

| Type of Restroom | Number of Restrooms | Total Number of Fixtures | | |
|-------------------------|----------------------------|---------------------------------|----------------|--------------|
| | | Toilets | Urinals | Sinks |
| Staff | 4 | 4 | | 4 |
| Girls | 2 | 5 | | 5 |
| Boys | 2 | 4 | 5 | 4 |
| Kinders | 1 | 1 | | 1 |
| MPR | 2 | 2 | | 2 |

Total number of drinking fountains on site = 23

| RIO DEL MAR ELEMENTARY SCHOOL , 819 Pinehurst Drive, Aptos, CA 95003, Ph: (831) 688-2053 Fax: 728-6467 Principal: Deborah Dorney Custodian: Jerry Lawson | | | | | | | | | | | | | | | |
|---|------------|----------------------------|-----------------|--------------------------------------|-----------------|-------------|----------------|-----------------|---------------|-------------|----------------|---------------|-----------------|----------------|--------------|
| Dist.# | Rm# | Use | Port/trl | Manufacturer | Date/Use | Size | Sq. Ft. | Dist/Own | FILE # | APP# | Lease # | P.O. # | Serial # | D.S.A.# | OPSC# |
| 43-R433 | 18 | 5th/6th- GRADE | RELO | MODTECH | 8/18/97 | 24'x40' | 960 | YES | 44-37 | | | | 24584-83 | 68292 | |
| 43-R434 | 19 | 6th- GRADE | RELO | MODTECH | 8/18/97 | 24'x40' | 960 | YES | 44-37 | | | | 24586-85 | 68292 | |
| 43-R435 | 20 | 6th- GRADE | RELO | MODTECH | 10/1/98 | 24'x40' | 960 | NO | | MMMC | 122547 | C11143 | 36172-73 | 100910 | |
| 43-R429 | 21 | RSP | RELO | DOUPNIK | 9/13/89 | 24'x40' | 960 | YES | 44-37 | | | | 1099 | 47020 | 26193 |
| 43-R428 | 22 | 3rd- GRADE | RELO | D.M.S.I. | 7/9/89 | 24'x40' | 960 | YES | 44-37 | 25/69799-49 | | | | 51263 | 28868 |
| 43-R427 | 23 | 5th- GRADE | RELO | D.M.S.I. | 7/9/89 | 24'x40' | 960 | YES | 44-37 | 25/69799-49 | | | | 51884 | 28867 |
| 43-R432 | 24 | 3rd- GRADE | RELO | DOUPNIK | 4/15/90 | 24'x40' | 960 | YES | 44-37 | | | | 83A/B | 53429 | 28624 |
| 43-R431 | 25&26 | 3rd- GRADE | RELO | MODTECH | 8/18/97 | 36'x40' | 1440 | YES | 44-37 | | | | 24632 | 68292 | |
| 43-R426 | 27 | STORAGE ROOM | RELO | STEELGUARD | 1975 | 14'x60 | 840 | YES | | | | | | 44501 | |
| 43- | 28 | SDC | RELO | MODTECH | 8/18/03 | 24'x40' | 960 | YES | | | | | 59306-07 | 105181 | |
| 10 UNITS TOTAL | | 10 CLASSROOMS - DSA | | 1 STORAGE ROOM NON-CONFORMING | | | 9960 | | | | | | | | |

Grey Shaded Area = NON-CONFORMING Buildings

Yellow Shaded Area = Permanent Classroom Units on Concrete Foundations