

**Radcliff Elementary School**

550 Rodriguez Street, Watsonville, CA 95076

Aerial Photo Taken 3/8/06

 = Fire Riser Location

 = Fire Hydrant Location

# Radcliff Elementary School

550 Rodriguez St. Watsonville, CA. 95076  
Evacuation Map 2010-2011

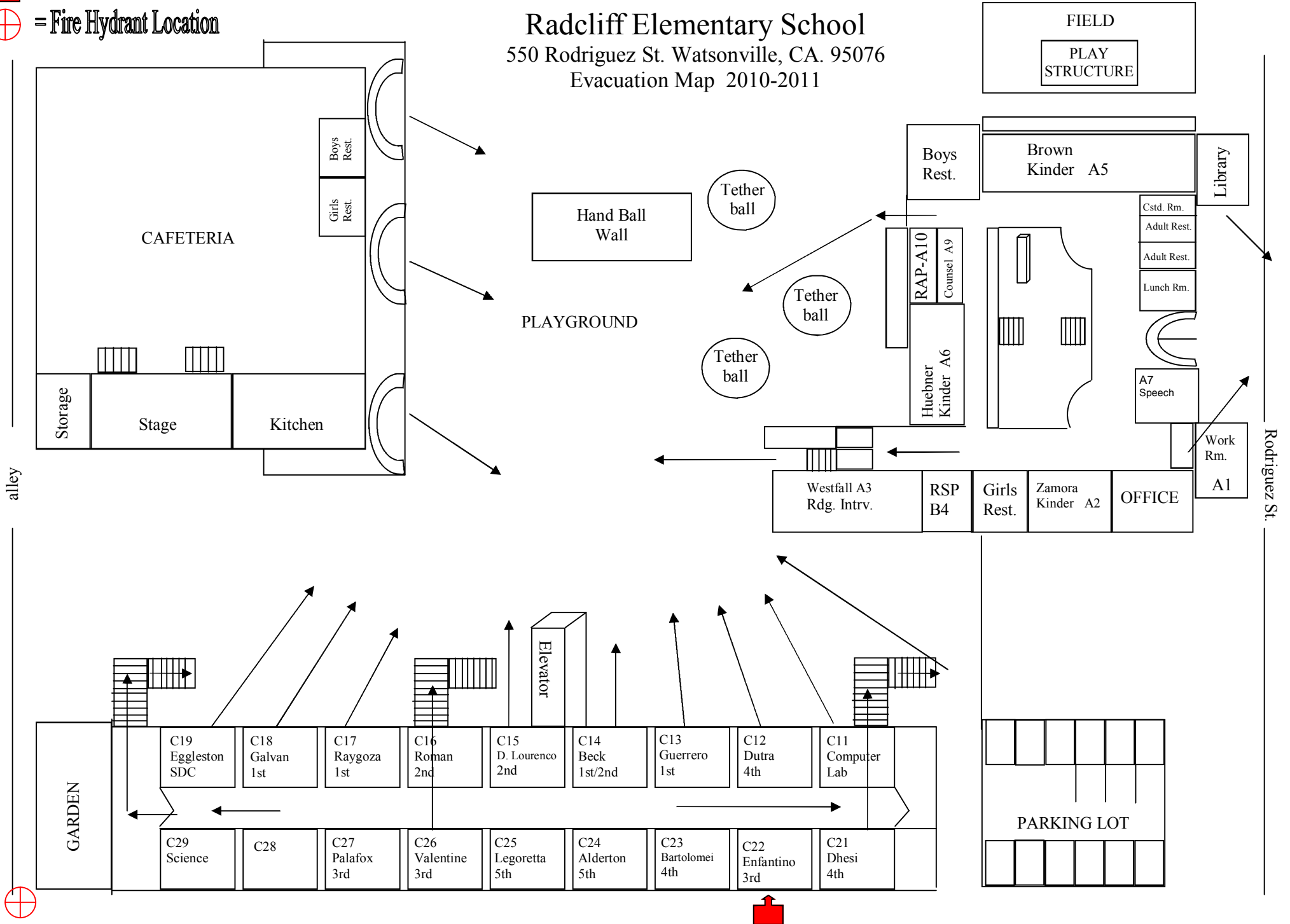

# Radcliff School Elementary School

550 Rodriguez Street, Watsonville, CA 95076

Phone: (831) 728-6469 Fax: (831) 728-8171

APN No. 018-231-49

3.72 Total Usable Acreage - 0 Total Unusable Acreage

Updated 3/2011

## Gross Sq. Ft. Site Use Summary

Permanent	Classrooms	sq. ft.	2,827	5	rooms
Relocatable	Classrooms	sq. ft.	17,280	18	rooms
Permanent	Staff Area	sq. ft.	1,950	8	rooms
Permanent	Library	sq. ft.	1,224	1	rooms
Permanent	Restrooms-Staff	sq. ft.	319	3	rooms
Permanent	Restrooms-Students	sq. ft.	1,120	6	rooms
Permanent	Multi-Purpose Room	sq. ft.	4,736	3	rooms
Permanent	Kitchen	sq. ft.	476	1	rooms
Permanent	Mechanical/Custodial Rooms	sq. ft.	651	11	rooms
Relocatable	Computer Lab(s)			1	rooms
Relocatable	Science Lab(s)			1	rooms
	Total Teaching Stations			23	rooms
Permanent	Roof Area	19,314	sq. ft.		
Permanent	A.C. Play Area/Parking Area	13,200	sq. ft.	34	spaces
Permanent	Play Box Structure	1000	sq. ft.	1	
	<b>TOTAL Building</b>	<b>sq. ft.</b>	<b>30,583</b>		

## WING "A"

Administration Wing & 7 Classrooms, built in 1928, D.S.A. No. N/A

Permanent	Classrooms	sq. ft.	2,827	5	rooms
Permanent	Classrooms - Kindergarten	sq. ft.	2,349	2	rooms
Permanent	Staff Room/Office Area	sq. ft.	1,950	8	rooms
Permanent	Restroom- Staff	sq. ft.	319	3	rooms
Permanent	Restroom - Boys	sq. ft.	266	2	rooms
Permanent	Restroom - Girls	sq. ft.	243	2	rooms
Permanent	Library	sq. ft.	1,224	1	rooms
Permanent	Mechanical/Custodial Room	sq. ft.	534	9	rooms
Permanent	Roof Area	12,474	sq. ft.		
	<b>TOTAL Building</b>	<b>sq. ft.</b>	<b>9,712</b>		

## **WING "B"**

Multi-Purpose Room/Cafeteria, built in 2004, D.S.A. No. 01-101962

Permanent	Multi-Purpose Room	sq. ft.	4,056	1	rooms
Permanent	Kitchen	sq. ft.	476	1	rooms
Permanent	Restroom - Boys	sq. ft.	286	1	rooms
Permanent	Restroom - Girls	sq. ft.	325	1	rooms
Permanent	Stage	sq. ft.	680	2	rooms
Permanent	Mechanical/Custodial Room	sq. ft.	117	2	rooms
Permanent	Roof Area	<b>6,840</b>	sq. ft.		
	<b>TOTAL Building</b>	<b>sq. ft.</b>	<b>5,940</b>		

## **Restroom Facility Counts for Radcliff**

<b>Type of Restroom</b>	<b>Number of Restrooms</b>	<b>Total Number of Fixtures</b>		
		<b>Toilets</b>	<b>Urinals</b>	<b>Sinks</b>
Staff	2	2		2
Girls	2	9		6
Boys	2	5	3	6
Kinders	2	2		2
Library	1	1		1
Nurse	1	1		1

**Total number of drinking fountains on site = 36**



**RADCLIFF ELEMENTARY SCHOOL**, 550 Rodriguez Street, Watsonville, CA 95076 Ph: (831) 728-6469 Fax: (831) 728-8171 Principal: Ulli Kummerow Custodian: Jaime Rosillo

Dist.#	Rm#	Use	Port/trl	Manufacturer	Date/Use	Size	Sq. Ft.	Dist/Own	FILE #	APP#	Lease #	P.O. #	Serial #	D.S.A.#	OPSC#
42-	Rm. 11	COMPUTER LAB	RELO	MODTECH	Aug-04	24'x40'	960	YES	44-37				60258-59	101962	
42-	Rm. 12	1st- GRADE	RELO	MODTECH	Aug-04	24'x40'	960	YES	44-37				60256-57	101962	
42-	Rm. 13	1st- GRADE	RELO	MODTECH	Aug-04	24'x40'	960	YES	44-37				60254-55	101962	
42-	Rm. 14	2nd-GRADE	RELO	MODTECH	Aug-04	24'x40'	960	YES	44-37				60252-53	101962	
42-	Rm. 15	2nd-GRADE	RELO	MODTECH	Aug-04	24'x40'	960	YES	44-37				60250-51	101962	
42-	Rm. 16	2nd-GRADE	RELO	MODTECH	Aug-04	24'x40'	960	YES	44-37				60248-49	101962	
42-	Rm. 17	2nd-GRADE	RELO	MODTECH	Aug-04	24'x40'	960	YES	44-37				20646-47	101962	
42-	Rm. 18	2nd-GRADE	RELO	MODTECH	Aug-04	24'x40'	960	YES	44-37				60244-45	101962	
42-	Rm. 19	SDC	RELO	MODTECH	Aug-04	24'x40'	960	YES	44-37				60242-43	101962	
42	Rm. 21	STAFF ROOM	RELO	MODTECH	Aug-04	24'x40'	960	YES	44-37				60276-77	101962	
42-	Rm. 22	3rd- GRADE	RELO	MODTECH	Aug-04	24'x40'	960	YES	44-37				60274-75	101962	
42-	Rm. 23	3rd- GRADE	RELO	MODTECH	Aug-04	24'x40'	960	YES	44-37				60272-73	101962	
42-	Rm. 24	4th- GRADE	RELO	MODTECH	Aug-04	24'x40'	960	YES	44-37				60270-71	101962	
42-	Rm. 25	3rd- GRADE	RELO	MODTECH	Aug-04	24'x40'	960	YES	44-37				60268-69	101962	
42-	Rm. 26	4th- GRADE	RELO	MODTECH	Aug-04	24'x40'	960	YES	44-37				60266-67	101962	
42-	Rm. 27	5th- GRADE	RELO	MODTECH	Aug-04	24'x40'	960	YES	44-37				20664-65	101962	
42-	Rm. 28	5th- GRADE	RELO	MODTECH	Aug-04	24'x40'	960	YES	44-37				20662-63	101962	
42-	Rm. 29	SCIENCE - MATH	RELO	MODTECH	Aug-04	24'x40'	960	YES	44-37				60260-61	101962	
<b>18-UNITS TOTAL</b>	<b>17 CLASSROOMS - DSA</b>	<b>1 STAFF ROOM - DSA</b>					<b>17280</b>								

Grey Shaded Area = NON-CONFORMING Buildings

Yellow Shaded Area = Permanent Classroom Units on Concrete Foundation