

Site View



Pajaro Valley High School—Site View

500 Harkin Slough Road
Aerial Photo Taken 4/6/09

Wetlands Educational
Resource Center

Student Parking

Staff Parking

J - Wing
101 to 104

K - Wing
rooms 101 to 109

C - Wing
Cafeteria

H - Wing

Gym
& Locker
Rooms

Lunch
Shelters

Quad

A - Wing

Office

B - Wing
Library

E - Wing

F - Wing
101 - 107



Pajaro Valley High School

500 Harkins Slough Road, Watsonville, CA 95076

Aerial Photo Taken 4/6/09

F107 F106 F105 F104 F103 F102 F101

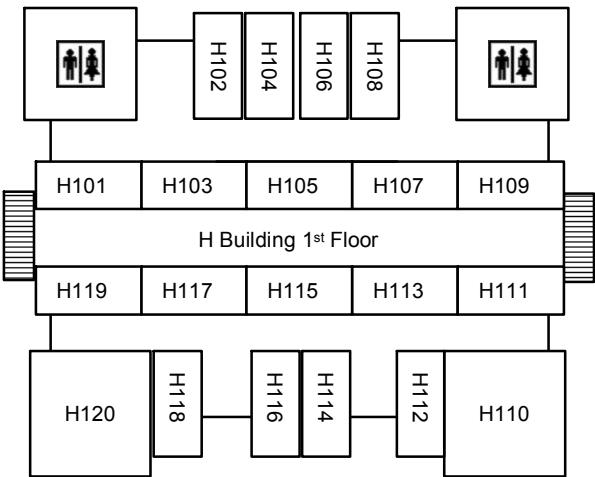
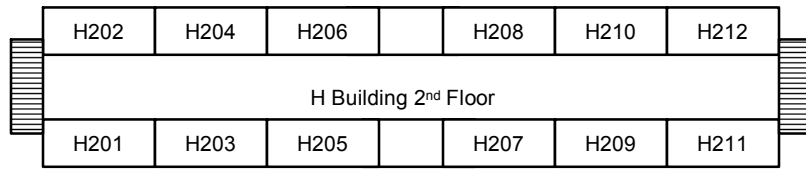
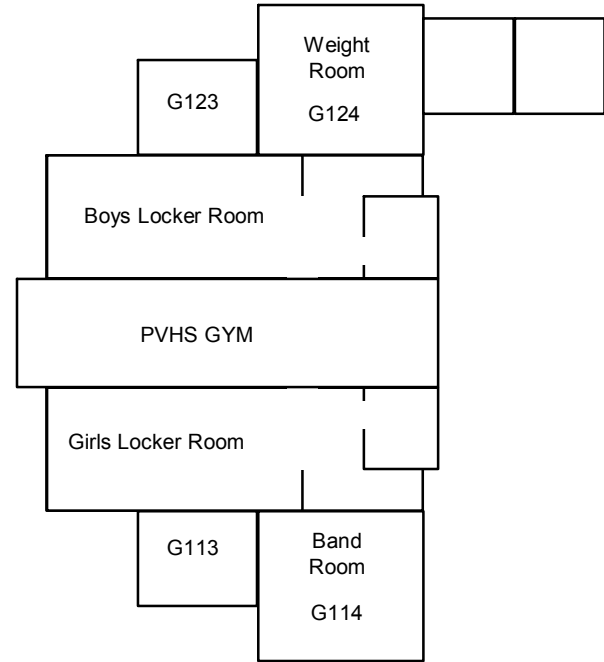
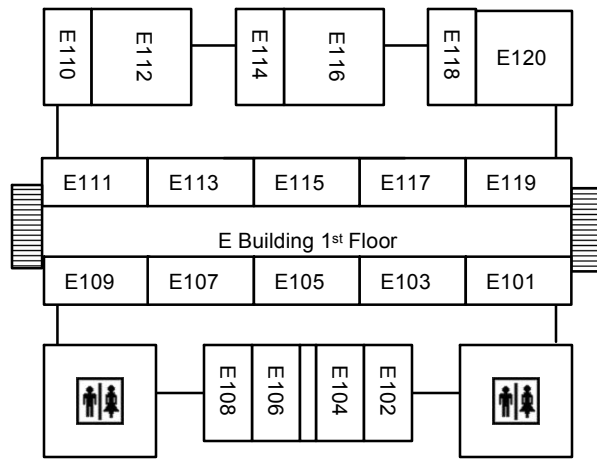
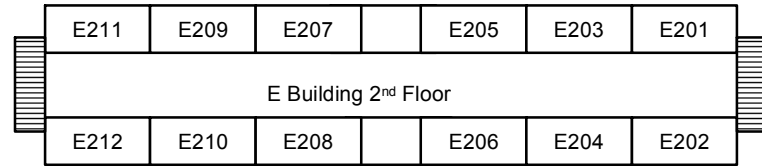

J101
J102
J103
J104

Pajaro Valley High School



K109 K108 K107 K106 K105 K104 K103 K102 K101

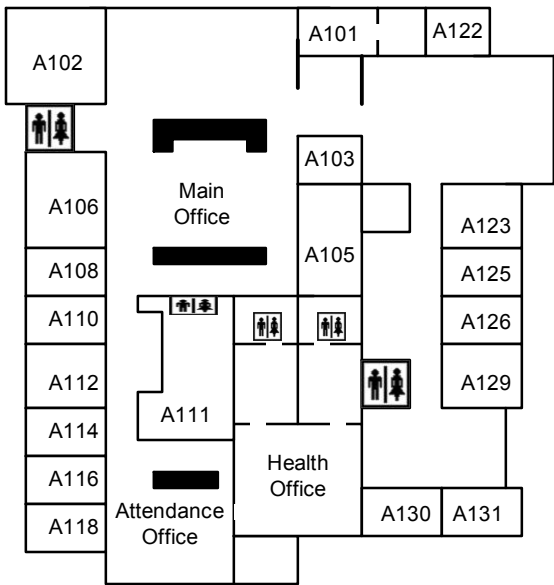
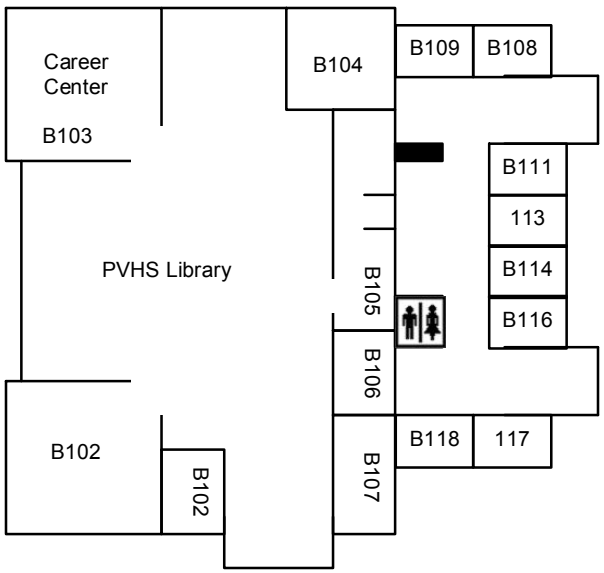

Pajaro Valley High School
 500 Harkin Slough Road, Watsonville, CA 95076
 Phone: (831)728-8102 Fax: (831) 728-6944

APN No. 018-281-19
 70.46 Total Acreage - 36.94 Total Unusable Acreage
 Updated 3/2011

Gross Sq. Ft. Site Use Summary

| | | | | | |
|-------------|-------------------------------|----------------|----------------|-----|--------|
| Permanent | Classrooms | sq. ft. | 70,848 | 69 | rooms |
| Relocatable | Classrooms | sq. ft. | 0 | 20 | rooms |
| Permanent | Staff Area | sq. ft. | 19,797 | 58 | rooms |
| Permanent | Library | sq. ft. | 7,032 | 2 | rooms |
| Permanent | Gymnasium/Locker Rooms | sq. ft. | 18,517 | 3 | rooms |
| Permanent | Lobby/Closed Corridors | sq. ft. | 21,829 | 5 | rooms |
| Permanent | Restrooms-Staff | sq. ft. | 2,364 | 26 | rooms |
| Permanent | Restrooms-Students | sq. ft. | 4,625 | 12 | rooms |
| Permanent | Restrooms - Special Education | sq. ft. | 172 | 2 | rooms |
| Permanent | Cafeteria/Kitchen | sq. ft. | 4,825 | 1 | rooms |
| Permanent | Mechanical/Custodial Rooms | sq. ft. | 3,184 | 30 | rooms |
| Permanent | Storage | sq. ft. | 4,538 | 24 | rooms |
| Permanent | Science Center (WERC) | sq. ft. | 2,310 | 7 | rooms |
| Permanent | Science Lab(s) | sq. ft. | | 9 | rooms |
| Permanent | Computer Lab(s) | sq. ft. | | 2 | rooms |
| Permanent | Teaching Stations | sq. ft. | | 89 | rooms |
| Permanent | Roof Area | sq. ft. | | | rooms |
| Permanent | Parking Area/Walkways | 331,515 | sq. ft. | 438 | spaces |
| Permanent | A.C. Bus Lane Areas | 10,500 | | | |
| | | sq. ft. | | | |
| | | | | | |
| | TOTAL Building | sq. ft. | 160,041 | | |
| | | | | | |

WING "A"

Administration wing, built in 2003, D.S.A. No. 01-103462

| | | | | | |
|-----------|---------------------------|----------------|---------------|----|-------|
| Permanent | Staff Room/Office Area | sq. ft. | 10,205 | 30 | rooms |
| Permanent | Restroom- Staff | sq. ft. | 627 | 7 | rooms |
| Permanent | Mechanical/Custodial Room | sq. ft. | 250 | 2 | rooms |
| Permanent | Roof Area | 12,584 | sq. ft. | | |
| | | | | | |
| | TOTAL Building | sq. ft. | 11,082 | | |
| | | | | | |

WING "B"

Library, Built in 2003, D.S.A. No. 01-103462

| | | | | | |
|-----------|---------------------------|----------------|---------------|----|-------|
| Permanent | Classrooms | sq. ft. | 2,103 | 2 | rooms |
| Permanent | Staff Room/ Office Area | sq. ft. | 3,494 | 15 | rooms |
| Permanent | Restroom - Staff | sq. ft. | 220 | 3 | rooms |
| Permanent | Library | sq. ft. | 7,032 | 2 | rooms |
| Permanent | Storage | sq. ft. | 930 | 2 | rooms |
| Permanent | Mechanical/Custodial Room | sq. ft. | 284 | 3 | rooms |
| Permanent | Roof Area | 15,205 | sq. ft. | | |
| | | | | | |
| | TOTAL Building | sq. ft. | 14,063 | | |
| | | | | | |

WING "C"

Cafeteria/Kitchen, Built in 2004, D.S.A. No. 01-105742

| | | | | | |
|-----------|---------------------------|----------------|---------------|---|-------|
| Permanent | Cafeteria/Kitchen | sq. ft. | 4,825 | 1 | rooms |
| Permanent | Staff Room/ Office Area | sq. ft. | 149 | 2 | rooms |
| Permanent | Restroom - Staff | sq. ft. | 368 | 3 | rooms |
| Permanent | Storage | sq. ft. | 984 | 4 | rooms |
| Permanent | Mechanical/Custodial Room | sq. ft. | 226 | 3 | rooms |
| Permanent | Roof Area & Lunch Shelter | sq. ft. | 10,152 | | |
| | | | | | |
| | TOTAL Building | sq. ft. | 16,704 | | |
| | | | | | |

WING "E"

Classrooms, Built in 2003, D.S.A. No. 01-103462

| | | | | | |
|-----------|------------------------------|----------------|---------------|----|-------|
| Permanent | Classrooms | sq. ft. | 29,929 | 30 | rooms |
| Permanent | Office/Staff Area | sq. ft. | 3,500 | 6 | rooms |
| Permanent | Restroom - Boys | sq. ft. | 692 | 2 | rooms |
| Permanent | Restroom - Girls | sq. ft. | 916 | 2 | rooms |
| Permanent | Restroom - Staff | sq. ft. | 655 | 7 | rooms |
| Permanent | Restroom - Special Education | sq. ft. | 86 | 1 | rooms |
| Permanent | Storage | sq. ft. | 1,076 | 6 | rooms |
| Permanent | Mechanical/Custodial Room | sq. ft. | 840 | 6 | rooms |
| Permanent | Corridor - Closed | sq. ft. | 9,172 | 1 | |
| Permanent | Roof Area | 48,146 | sq. ft. | | |
| | | | | | |
| | TOTAL Building | sq. ft. | 46,866 | | |
| | | | | | |

WING "G"

Gymnasium/Locker Rooms, Built in 2003, D.S.A. No. 01-103462

| | | | | | |
|-----------|---------------------------|----------------|---------------|---|-------|
| Permanent | Classrooms | sq. ft. | 6,364 | 5 | rooms |
| Permanent | Gymnasium | sq. ft. | 13,464 | 1 | rooms |
| Permanent | Locker Rooms - Boys | sq. ft. | 2,455 | 1 | rooms |
| Permanent | Locker Rooms - Girls | sq. ft. | 2,598 | 1 | rooms |
| Permanent | Lobby | sq. ft. | 1,065 | 3 | rooms |
| Permanent | Office/Staff Area | sq. ft. | 771 | 2 | rooms |
| Permanent | Restroom - Boys | sq. ft. | 722 | 2 | rooms |
| Permanent | Restroom - Girls | sq. ft. | 727 | 2 | rooms |
| Permanent | Storage | sq. ft. | 1,112 | 2 | rooms |
| Permanent | Mechanical/Custodial Room | sq. ft. | 714 | 8 | rooms |
| Permanent | Roof Area | | 30,463 | | |
| | | | | | |
| | TOTAL Building | sq. ft. | 29,992 | | |
| | | | | | |

WING "H"

Classrooms, Built in 2003, D.S.A. No. 01-103462

| | | | | | |
|-----------|------------------------------|----------------|---------------|----|-------|
| Permanent | Classrooms | sq. ft. | 30,418 | 30 | rooms |
| Permanent | Office/Staff Area | sq. ft. | 1,592 | 2 | rooms |
| Permanent | Restroom - Staff | sq. ft. | 354 | 4 | rooms |
| Permanent | Restroom - Boys | sq. ft. | 672 | 2 | rooms |
| Permanent | Restroom - Girls | sq. ft. | 896 | 2 | rooms |
| Permanent | Restroom - Special Education | sq. ft. | 86 | 1 | rooms |
| Permanent | Storage | sq. ft. | 436 | 10 | rooms |
| Permanent | Mechanical/Custodial Room | sq. ft. | 820 | 6 | rooms |
| Permanent | Corridor - Closed | sq. ft. | 11,592 | 1 | |
| Permanent | Roof Area | | 48,146 | | |
| | | | | | |
| | TOTAL Building | sq. ft. | 46,866 | | |
| | | | | | |

W.E.R.C. - Natural History Science Center

Classrooms, Built in 2004, D.S.A. No. 01-105338

| | | | | | |
|-----------|---------------------------|----------------|--------------|---|-------|
| Permanent | Classrooms | sq. ft. | 2,034 | 2 | rooms |
| Permanent | Office/Staff Area | sq. ft. | 86 | 1 | rooms |
| Permanent | Restroom - Staff | sq. ft. | 140 | 2 | rooms |
| Permanent | Mechanical/Custodial Room | sq. ft. | 50 | 2 | rooms |
| Permanent | Roof Area | | 2,600 | | |
| | | | | | |
| | TOTAL Building | sq. ft. | 2,310 | | |
| | | | | | |

Restroom Facility Counts for PVHS

| Type of Restroom | Number of Restrooms | Total Number of Fixtures | | |
|------------------|---------------------|--------------------------|---------|-------|
| | | Toilets | Urinals | Sinks |
| Staff | 21 | 21 | 1 | 21 |
| Girls | 8 | 40 | | 25 |
| Boys | 8 | 14 | 25 | 24 |
| | | | | |

Total number of drinking fountains on site = 17

| PAJARO VALLEY HIGH SCHOOL , 500 Harkin Slough, Watsonville, CA 95076 Ph: (831) 728-8102 Fax: (831) 728-6944 | | | | | | | | | | | | | | Principal: Pancho Rodriguez | | Custodian: Richard Brewer | |
|--|------------|--------------------------|-----------------|---------------------|-----------------|-------------|----------------|-----------------|---------------|-------------|----------------|---------------|-----------------|-----------------------------|--------------|---------------------------|--|
| <u>Dist.#</u> | <u>Rm#</u> | <u>Use</u> | <u>Port/trl</u> | <u>Manufacturer</u> | <u>Date/Use</u> | <u>Size</u> | <u>Sq. Ft.</u> | <u>Dist/Own</u> | <u>FILE #</u> | <u>APP#</u> | <u>Lease #</u> | <u>P.O. #</u> | <u>Serial #</u> | <u>D.S.A.#</u> | <u>OPSC#</u> | | |
| 6- | F101 | CLASSROOM | RELO | AMER. MOD. | Aug-04 | 24'x40' | 960 | YES | 44-37 | | | | 05113010A-B | 106998 | | | |
| 6- | F102 | CLASSROOM | RELO | AMER. MOD. | Aug-04 | 24'x40' | 960 | YES | 44-37 | | | | 05113011A-B | 106998 | | | |
| 6- | F103 | CLASSROOM | RELO | AMER. MOD. | Aug-04 | 24'x40' | 960 | YES | 44-37 | | | | 05113012A-B | 106998 | | | |
| 6- | F104 | CLASSROOM | RELO | AMER. MOD. | Aug-04 | 24'x40' | 960 | YES | 44-37 | | | | 05113013A-B | 106998 | | | |
| 6- | F105 | CLASSROOM | RELO | AMER. MOD. | Aug-04 | 24'x40' | 960 | YES | 44-37 | | | | 05113014A-B | 106998 | | | |
| 6- | F106 | CLASSROOM | RELO | AMER. MOD. | Aug-04 | 24'x40' | 960 | YES | 44-37 | | | | 05113015A-B | 106998 | | | |
| 6- | F107 | CLASSROOM | RELO | AMER. MOD. | Aug-04 | 24'x40' | 960 | YES | 44-37 | | | | 05113016A-B | 106998 | | | |
| 6- | J101 | CLASSROOM | RELO | AMER. MOD. | Aug-04 | 24'x40' | 960 | YES | 44-37 | | | | 05113017A-B | 106998 | | | |
| 6- | J102 | CLASSROOM | RELO | AMER. MOD. | Aug-04 | 24'x40' | 960 | YES | 44-37 | | | | 05113018A-B | 106998 | | | |
| 6- | J103 | CLASSROOM | RELO | AMER. MOD. | Aug-04 | 24'x40' | 960 | YES | 44-37 | | | | 05113019A-B | 106998 | | | |
| 6- | J104 | CLASSROOM | RELO | AMER. MOD. | Aug-04 | 24'x40' | 960 | YES | 44-37 | | | | 05113020A-B | 106998 | | | |
| 6- | K101 | CLASSROOM | RELO | AMER. MOD. | Aug-04 | 24'x40' | 960 | YES | 44-37 | | | | 05113001A-B | 106998 | | | |
| 6- | K102 | CLASSROOM | RELO | AMER. MOD. | Aug-04 | 24'x40' | 960 | YES | 44-37 | | | | 05113002A-B | 106998 | | | |
| 6- | K103 | CLASSROOM | RELO | AMER. MOD. | Aug-04 | 24'x40' | 960 | YES | 44-37 | | | | 05113003A-B | 106998 | | | |
| 6- | K104 | CLASSROOM | RELO | AMER. MOD. | Aug-04 | 24'x40' | 960 | YES | 44-37 | | | | 05113004A-B | 106998 | | | |
| 6- | K105 | CLASSROOM | RELO | AMER. MOD. | Aug-04 | 24'x40' | 960 | YES | 44-37 | | | | 05113005A-B | 106998 | | | |
| 6- | K106 | CLASSROOM | RELO | AMER. MOD. | Aug-04 | 24'x40' | 960 | YES | 44-37 | | | | 05113006A-B | 106998 | | | |
| 6- | K107 | CLASSROOM | RELO | AMER. MOD. | Aug-04 | 24'x40' | 960 | YES | 44-37 | | | | 05113007A-B | 106998 | | | |
| 6- | K108 | CLASSROOM | RELO | AMER. MOD. | Aug-04 | 24'x40' | 960 | YES | 44-37 | | | | 05113008A-B | 106998 | | | |
| 6- | K109 | CLASSROOM | RELO | AMER. MOD. | Aug-04 | 24'x40' | 960 | YES | 44-37 | | | | 05113009A-B | 106998 | | | |
| 20 UNITS TOTAL | | 20 CLASSROOMS-DSA | | | | | 19200 | | | | | | | | | | |

Grey Shaded Area = NON-CONFORMING Buildings
Yellow Shaded Area = Permanent Classroom Units on Concrete Foundation