

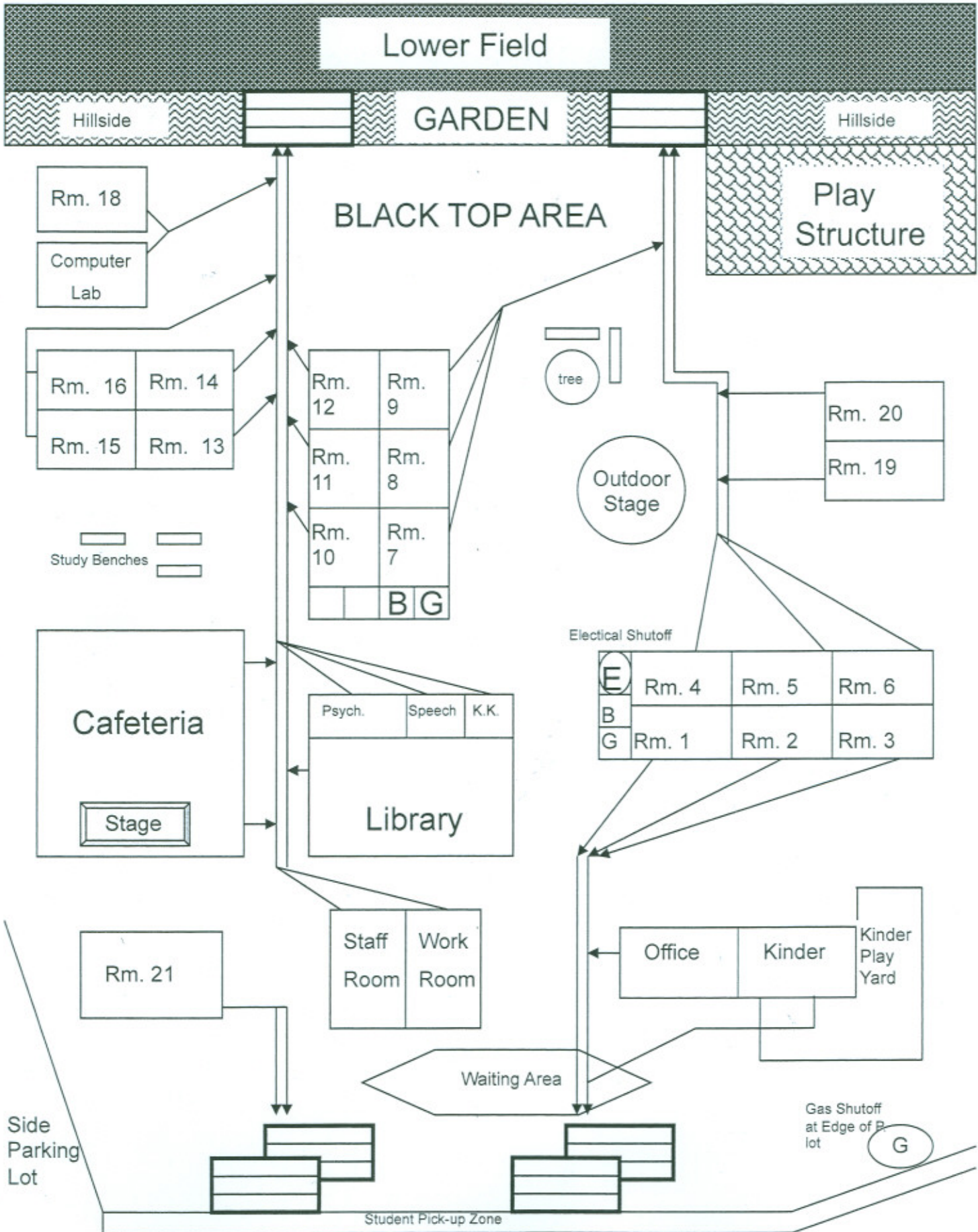

Mar Vista Elementary School
6860 Soquel Drive, Aptos, CA 95003
Aerial Photo Taken 4/26/03



Mar Vista Evacuation Map

(W) Water Shutoff at Street

Drive Way

Gas Shutoff at Edge of Parking Lot (G)

WING "B"

Classroom 1 - 6 built in 1964, D.S.A.No. 24771

Permanent	Classrooms	sq. ft.	6,000	6	rooms
Permanent	Restroom- Staff	sq. ft.	50	1	rooms
Permanent	Restroom- Boys	sq. ft.	152	1	rooms
Permanent	Restroom- Girls	sq. ft.	152	1	rooms
Permanent	Mechanical/Custodial Room	sq. ft.	499	3	rooms
Permanent	Storage	sq. ft.	126	1	rooms
Permanent	Cover Corridor/Walkways	1,041	sq. ft.		
Permanent	Roof Area	7,001	sq. ft.		
	TOTAL Building	sq. ft.	6,979		

WING "C"

Classroom 7 - 12 built in 1964, D.S.A. No.24777

Permanent	Classroom	sq. ft.	6,000	6	rooms
Permanent	Restroom- Staff	sq. ft.	50	1	rooms
Permanent	Restrooms- Boys	sq. ft.	152	1	rooms
Permanent	Restrooms- Girls	sq. ft.	152	1	rooms
Permanent	Mechanical/Custodial Room	sq. ft.	499	3	rooms
Permanent	Storage	sq. ft.	126	1	rooms
Permanent	Covered Corridors/Walkways	1,041	sq. ft.		
Permanent	Roof Area	7,001	sq. ft.		
	TOTAL Building	sq. ft.	6,979		

WING "D"

Multi-Purpose Room built in 1965, D.S.A. No.26306

Permanent	Kitchen	sq. ft.	423	1	rooms
Permanent	Multi-Purpose Room	sq. ft.	3,227	1	rooms
Permanent	Restroom- Staff	sq. ft.	35	1	rooms
Permanent	Restrooms- Boys	sq. ft.	51	1	rooms
Permanent	Restrooms- Girls	sq. ft.	58	1	rooms
Permanent	Mechanical/Custodial Room	sq. ft.	193	1	rooms
Permanent	Storage	sq. ft.	149	2	rooms
Permanent	Entry Way	sq. ft.	105	1	
Permanent	Vestibule	sq. ft.	51	1	rooms
Permanent	Covered Corridors/Walkways	580	sq. ft.		
Permanent	Roof Area	4,300	sq. ft.		
	TOTAL Building	sq. ft.	4,292		

WING "E"

Work Room & Staff Lounge built in 1965, D.S.A. No.26306

Permanent	Work Room	sq. ft.	331	1	rooms
Permanent	Staff Room	sq. ft.	850	1	rooms
Permanent	Covered Corridors/Walkways	192	sq. ft.		
Permanent	Roof Area	1,700	sq. ft.		
	TOTAL Building	sq. ft.	1,181		

WING "F"

Library built in 1965, D.S.A. No.26306

Permanent	Library	sq. ft.	1,230	1	rooms
Permanent	Center	sq. ft.	140	1	rooms
Permanent	Work Room	sq. ft.	145	1	rooms
Permanent	Special Education Room	sq. ft.	204	1	rooms
Permanent	Covered Corridors/Walkways	100	sq. ft.		
Permanent	Roof Area	2,209	sq. ft.		
	TOTAL Building	sq. ft.	1,719		

WING "G"

Classroom 13 - 16 built in 1965, D.S.A. No. 26306

Permanent	Classrooms	sq. ft.	4,032	4	rooms
Permanent	Mechanical/Custodial Room	sq. ft.	171	1	
Permanent	Covered Corridors/Walkways	636	sq. ft.		
Permanent	Roof Area	4,800	sq. ft.		
	TOTAL Building	sq. ft.	4,203		

Santa Cruz County Recreation Building

Relocatable	S.C. County Recreation Classroom	sq. ft.	1,440	2	rooms
Relocatable	Roof Area	1,536	sq. ft.		
	TOTAL Building	sq. ft.	1,440		

Restroom Facility Counts for Mar Vista

Type of Restroom	Number of Restrooms	Total number of Fixtures		
		Toilets	Urinals	Sinks
Staff	6	6		6
Girls	2	5		3
Boys	2	4	3	4
Kinder	1	1		1

Total number of Drinking Fountains on site = 31

MAR VISTA ELEMENTARY SCHOOL, 6860 Soquel Drive, Aptos, CA 95003, Ph: (831) 761-6177 Fax: (831) 728-6491 Principal: Christopher Hertz Custodian: Kirk Durand															
Dist.#	Rm#	Use	Port/trl	Manufacturer	Date/Use	Size	Sq. Ft.	Dist/Own	FILE #	APP#	Lease #	P.O. #	Serial #	D.S.A.#	OPSC#
40-R328	17	4th- GRADE	RELO	D.M.S.I.	1/2/89	24'x40'	960	YES	44-37	25/69799-39			1176	50180	27807
40-R329	18	LANGUAGE LAB	RELO	D.M.S.I.	1/2/89	24'x40'	960	YES	44-37	25/69799-39			1670-1-2	50180	27819
40-R330	19-20	SC-REC.&CR.	RELO	AMER. MOD.	12/1/01	24'x60'	1440	NO	44-37	Purchased by SC. County Rec.			01-607-002 A/B	104234	
40-R327	21	KINDERGARTEN	RELO	MODTECH	1997	24'x40'	960	YES	43-47				31981	100021	
4 UNITS TOTAL		5 CLASSROOMS-DSA					4320								
		1 S.C.Rec. Dept. Classroom-DSA													

Grey Shaded Area = NON-CONFORMING Buildings

Yellow Shaded Area = Permanent Classroom Units on Concrete Foundations