

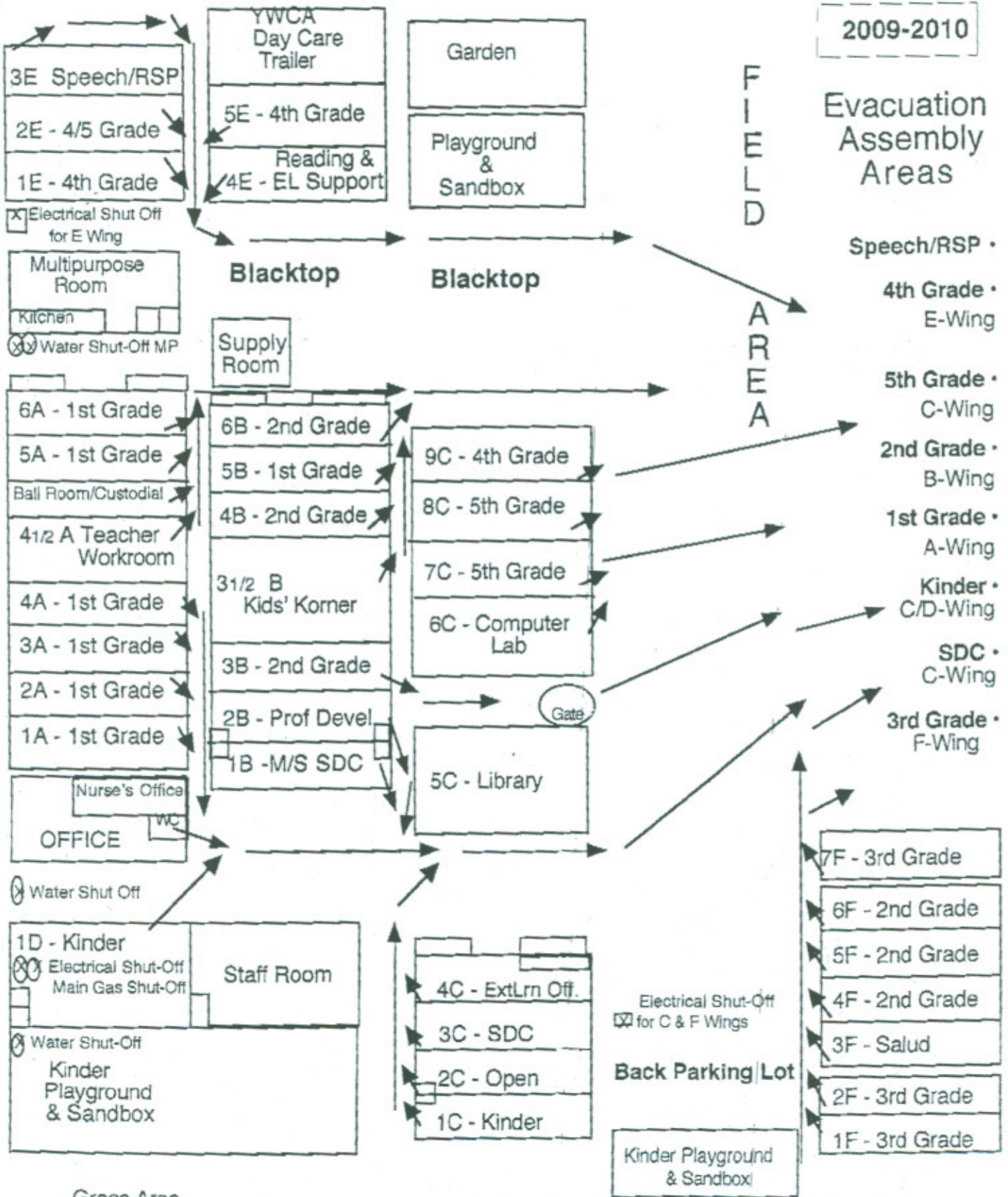

MacQuiddy Elementary School
330 Martinelli Street, Watsonville, CA 95076
Aerial Photo Taken 3/8/06

MACQUIDDY SCHOOL EMERGENCY/FIRE EXIT MAP

2009-2010



2010-2011

T.S. MacQuiddy Elementary

School Map/Phone Ext's.

3E-Speech 4334 A. Trudell	3E-RSP 4323 TBH	YWCA Trailer 763-0624 (Not PVUSD Property)		Grass Area		All Page: #31 _ 0	
4th Gr. Rigler	2E 4324	5E 4354 Bradwell	4th Gr.	Play Structures			
4th Gr. TBH	1E 4314	4E 4344 Gonzales	5th	Grass			
B. Beardsley PE Office 4397		Paved Playing Area					Play Area
Cafeteria /MPR Kitchen 4381 4382		Supply Store					Smart Board
Girl's RR	Boy's RR	Girl's RR	Boy's RR	9C 4309 Silva	5th Gr.		Grass Play Area
2nd Gr. Dolden	6A 4360	2nd Gr. Niland	6B 4361	8C 4308 Gaebe	5th Gr.		
1st Gr. Fajardo	5A 4350	2nd Gr. Nathan	5B 4351	7C 4307 Moore	M/M 3rd-5th		
Book Storage	Custodial Closet	2nd Gr. Howard	4B 4341	6C Computer Lab 4362			
Teacher Workroom	4 1/2A 4345	KidsKorner	3 1/2B 4337	Grass Area			
1st Gr. Vang	4A 4340	2nd Gr. Hernandez	3B 4331	5C Library 4352 Y. Danna	Migrant Ed 4396 D. Muñoz		
1st Gr. Phipps-Craig	3A 4330	Kinder Pantoja	2B 4321	7F 4317 Morgan			
1st Gr. Raygoza	2A 4320	Child RR	Book Storage	5F 4365 Manler			
1st Gr. Strang	1A 4310	Kinder Macias	1B 4311	5F 4355 Satellite Computer Lab			
Principal 4375	Curr Coord 4370	Grass Area		Girl's RR Custodian	Boy's RR 4389	4F 4345 TBD	
Ofc Mgr 4376	Health Aide 4360/4392	Grass Area		4C 4342	Cesarello ELP Office	3F 4335 M/Th Salud para la Gente	
Main Off. 4372	Staff RR [Front Desk]			3C 4332 Niles	3rd Gr.	2F 4325 Blake 3rd Gr.	
1D 4313 Khan	Staff Rm. 4383			2C 4322 Lord	Kinder	1F 4315 Trybom 3rd Gr.	

**MacQuiddy Elementary School K-5
& Y.W.C.A. Childcare Center**
330 Martinelli Street, Watsonville, CA 95076
Phone: (831) 728-6315 Fax: (831) 728-6466

APN No. 019-111-02
8.8 Total /Usable Acreage- 0 Total Un-Usable Acreage
Updated 3/2011

Gross Sq. Ft. site use summary

Permanent	Classrooms	sq. ft.	20,291	19	rooms
Relocatable	Classrooms	sq. ft.	12,480	13	rooms
Relocatable	YWCA	sq. ft.	1,200	1	rooms
Relocatable	Library	sq. ft.	1,920	1	rooms
Permanent	Staff Area	sq. ft.	2,147	7	rooms
Permanent	Restroom-Staff	sq. ft.	353	6	rooms
Permanent	Restroom-Student	sq. ft.	1,112	7	rooms
Permanent	Multi-Purpose Room	sq. ft.	5,512	1	rooms
Permanent	Kitchen	sq. ft.	200	1	rooms
Permanent	Storage/Book Room	sq. ft.	1,408	6	rooms
Permanent	Mechanical/Custodial Room	sq. ft.	1,034	6	rooms
Permanent	Covered Walkways	8,671	sq. ft.		
Permanent	A.C. Play Area	33,004	sq. ft.		
Permanent	A.C. Total Road & Parking Area	29,185	sq. ft.	46	spaces
Permanent	Play Box Structure	17,587	sq. ft.	21	structures
Permanent	Life Lab Areas	616	sq. ft.		
Permanent	Roof Area	32,818	sq. ft.		
Relocatable	Roof Area	15,516	sq. ft.		
	Computer Lab(s)			1	rooms
	Science Lab(s)			0	rooms
	Total Teaching stations			32	rooms
	TOTAL Building	sq. ft.	47,657		

WING "A"

Admin. wing & classrooms 1A - 6A, built in 1949, D.S.A. No. 7098/48447

Permanent	Classrooms	sq. ft.	4,244	4	rooms
Permanent	Classrooms	sq. ft.	1,992	2	rooms
Permanent	Staff Room/Office Area	sq. ft.	1,331	6	rooms
Permanent	Restroom- Staff	sq. ft.	105	2	rooms
Permanent	Restroom- Boys	sq. ft.	224	1	rooms
Permanent	Restroom- Girls	sq. ft.	268	2	rooms
Permanent	Mechanical/Custodial Room	sq. ft.	707	2	rooms
Permanent	Storage/Book Room	sq. ft.	210	1	rooms
Permanent	Kindergarden	sq. ft.	1,407	1	rooms
Permanent	Covered Walkways	2,577	sq. ft.		
Permanent	Roof Area-	10,680	sq. ft.		
	TOTAL Building	sq. ft.	10,488		

WING "B"

Classrooms 1B - 6B (3-1/2 B), built in 1955, D.S.A. No.12948/59338

Permanent	Classrooms	sq. ft.	4,032	4	rooms
Permanent	Classrooms	sq. ft.	2,042	2	rooms
Permanent	Restroom- Staff	sq. ft.	112	2	rooms
Permanent	Restroom-Boys	sq. ft.	134	1	rooms
Permanent	Restroom-Girls	sq. ft.	134	1	rooms
Permanent	Mechanical/Custodial Room	sq. ft.	227	1	rooms
Permanent	Storage	sq. ft.	710	2	rooms
Permanent	Hall	sq. ft.	36	1	rooms
Permanent	Covered Walkways	1,467	sq. ft.		
Permanent	Covered Porches	506			
Permanent	Roof Area	7,720	sq. ft.		
	TOTAL Building	sq. ft.	7,427		

WING "C"

Classrooms 1C - 4C, built in 1949, D.S.A. No.7098

Permanent	Classroom	sq. ft.	1,904	1	rooms
Permanent	Classroom	sq. ft.	860	1	rooms
Permanent	Staff Restroom/Office Area	sq. ft.	288	1	rooms
Permanent	Restroom- Boys	sq. ft.	176	1	rooms
Permanent	Restroom- Girls	sq. ft.	176	1	rooms
Permanent	Storage	sq. ft.	408	2	rooms
Permanent	Covered Walkways	1,840	sq. ft.		
Permanent	Roof Area	4,026	sq. ft.		
	TOTAL Building	sq. ft.	3,812		

WING "C"

Classrooms 6C - 9C, built in 1989, D.S.A. No.52069

Permanent	Classrooms	sq. ft.	3,808	4	rooms
Permanent	Covered Walkways	1,395	sq. ft.		
Permanent	Roof Area	4,043	sq. ft.		
	TOTAL Building	sq. ft.	3,808		

MPR

Multi-Purpose Room, built in 1989, D.S.A. No.52069

Permanent	Multi-Purpose Room	sq. ft.	5,512	1	rooms
Permanent	Kitchen	sq. ft.	200	1	rooms
Permanent	Storage	sq. ft.	140	1	rooms
Permanent	Restroom- Staff	sq. ft.	136	2	rooms
Permanent	Covered Walkways 975	sq. ft.			
Permanent	Roof Area 6,349	sq. ft.			
	TOTAL Building	sq. ft.	5,988		

Y.W.C.A. Childcare Center

Relocatable	Y.W.C.A. Childcare Center	sq. ft.	1,296	1	rooms
Relocatable	Roof Area 1,612	sq. ft.			
	TOTAL Building	sq. ft.	1,296		

Restroom Facility Counts for MacQuiddy

Type of Restroom	Number of Restrooms	Total Number of Fixtures		
		Toilets	Urinals	Sinks
Staff	7	7		7
Girls	3	9		7
Boys	3	6	6	7
Kinders	3	3		3
Special Ed.	2	2		1

Total number of drinking fountains on site = 29

MACQUIDDY ELEMENTARY SCHOOL , 330 Martinelli Street, Watsonville, CA 95076, Ph: (831) 728-6315 Fax: (831) 728-6466 Principal: Tom Hiltz Custodian: Jose Yanez															
Dist.#	Rm#	Use	Port/trl	Manufacturer	Date/Use	Size	Sq. Ft.	Dist/Own	FILE #	APP#	Lease #	P.O. #	Serial #	D.S.A.#	OPSC#
39-R312	5C	LIBRARY	RELO	STEELGUARD	1981	48'X40'	1920	YES	44-37					45195	
39-R303	1E	4th- GRADE	RELO	AURORA	6/6/86	24'x40'	960	NO	44-37	05/69799-02			1075	47147	00160
39-R302	2E	5th- GRADE	RELO	MODTECH	7/1/98	24'x40'	960	NO	44-37	MMMC	121686	101715	35444-45	100908	
39-R301	3E-A&B	SPEECH-RSP	RELO	MODTECH	10/1/98	24'x40'	960	NO	44-37	MMMC	122545	C11143	36168-69	100908	
39-R304	4E	4th- GRADE	RELO	DOUPNIK	5/4/86	24'x40'	960	NO	44-37	25/69799-09			1076	47020	26190
39-R305	5E	4th- GRADE	RELO	STEELGUARD	4/29/85	24'x40'	960	NO	44-37	05/69799-01			1074	47242	00152
39-R311	F1	3rd- GRADE	RELO	DOUPNIK	4/23/90	24'x40'	960	YES	44-37				76A/B	53429	28620
39-R310	F2	3rd- GRADE	RELO	DOUPNIK	4/23/90	24'x40'	960	YES	44-37				77A/B	53429	28621
39-R308	F3&F4	3rd- GRADE	RELO	MODTECH	7/1/97	36'x40'	1440	NO	44-37	MMMC	121951	101709	24623-25	67817	
39-R306	F5&F6	3rd- GRADE	RELO	MODTECH	7/1/97	36'x40'	1440	NO	44-37	MMMC	121952	101709	24626-28	67817	
39-R	F7	READING FIRST	RELO	MODTECH	8/18/03	24'x40'	960	YES	44-37				59300-59301	105182	
39-T602	YWCA	DAY CARE	TRAILER	MILLER STRUC.	1992	24'X50'	1200	NO-YWCA					24-6395		
12 UNITS TOTAL		12 CLASSROOMS - DSA		2- 44'X50' SF. AREA'S EXISTING			13680								
		1 LIBRARY - DSA		YWCA C.C.C.TRAILER- NON DSA											

Grey Shaded Area = NON-CONFORMING Buildings

Yellow Shaded Area = Permanent Classroom Units on Concrete Foundations