

# Site View



East Lake Avenue

Kelly Lake

Holohan Road

College Road





## Lakeview Middle School

2350 East Lake Avenue, Watsonville, CA 95076

Aerial Photo Taken 4/6/09



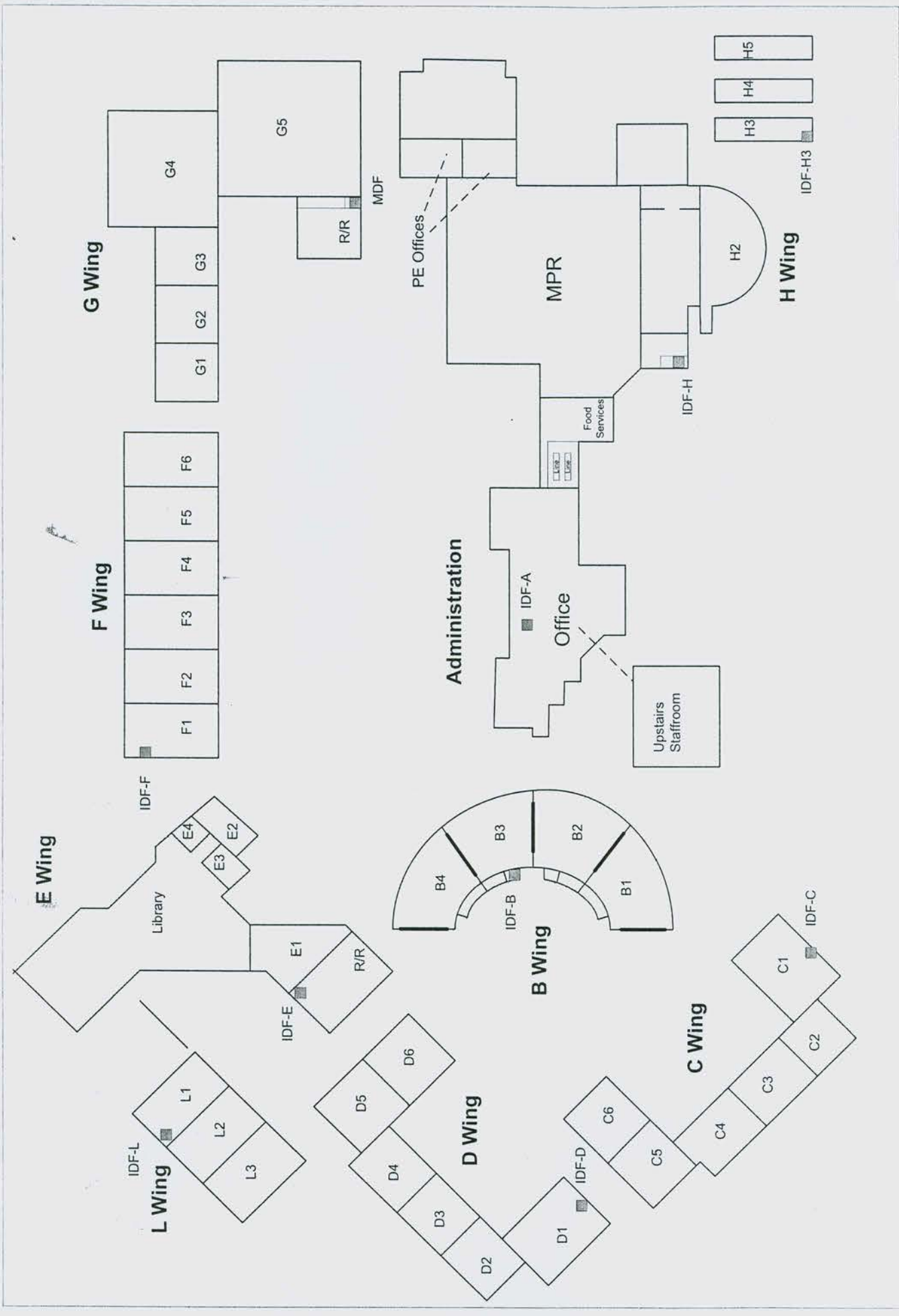

<b>Pajaro Valley Unified School District</b>	
Drawn: _____ Checked: _____ Issued: _____	<b>Lakeview Middle</b> ID: _____ Size: _____ Scale: _____ NTS
E-rate Year 12 Campus Layout	Rev: 0 Sheet: 1

# LAKEVIEW MIDDLE SCHOOL

2350 EAST LAKE AVENUE  
WATSONVILLE, CA 95076

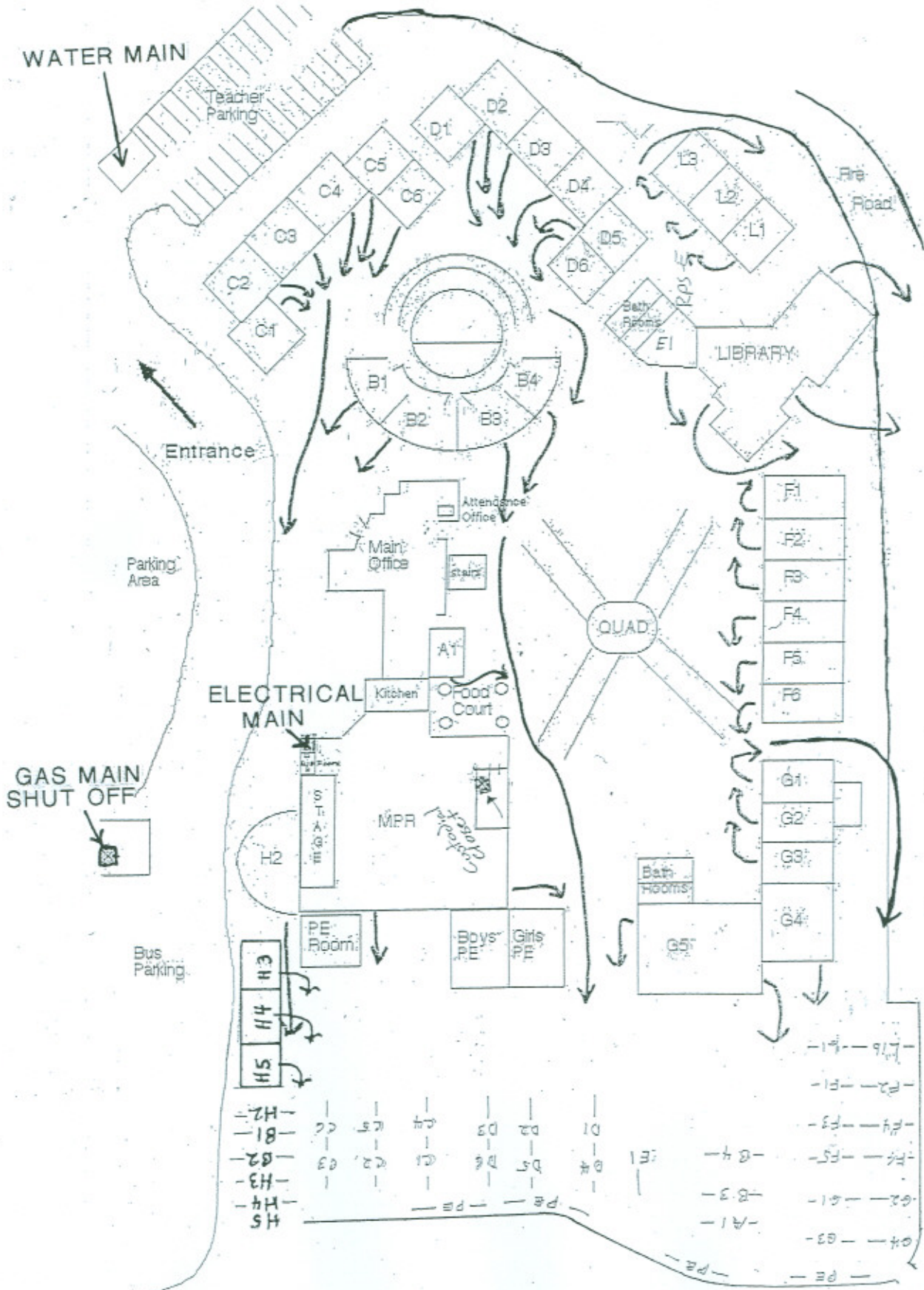

**Lakeview Middle School 6-8**  
 2350 East Lake Ave, Watsonville, CA 95076  
 Phone: (831) 728-6454 Fax: (831) 728-6480

051-501-12/051-501-17  
 15.8 Total Usable Acreage - 5 Total Unusable Acreage  
 Updated 3/2011

**Gross Sq. Ft. Site Use Summary**

Permanent	Classrooms	sq. ft.	30,482	26	rooms
Relocatables	Classrooms	sq. ft.	11,520	12	rooms
Permanent	Staff Area	sq. ft.	3,986	23	rooms
Permanent	Library	sq. ft.	3,823	1	rooms
Permanent	Restrooms-Staff	sq. ft.	1,055	10	rooms
Permanent	Restrooms-Student	sq. ft.	1,308	7	rooms
Permanent	Multi-Purpose Room	sq. ft.	6,600	1	rooms
Permanent	Kitchen	sq. ft.	885	1	rooms
Permanent	Mechanical/Custodial Rooms	sq. ft.	2,076	19	rooms
Permanent	A.C. Play Area	<b>21,756</b> sq. ft.			
Permanent	A.C. Total Road & Parking Area	<b>110,027</b> sq. ft.		113	spaces
Permanent	A.C. Bus Lane Areas	<b>35,829</b> sq. ft.			
Permanent	Covered Corridor/Walkways	<b>42,199</b> sq. ft.			
Permanent	Roof Area	<b>65,715</b> sq. ft.			
Relocatables	Roof Area	<b>12,000</b> sq. ft.			
	Science Lab(s)			4	rooms
	Computer Lab(s)			3	rooms
	Total Teaching stations			38	
	<b>TOTAL Building</b>	<b>sq. ft.</b>	<b>61,735</b>		

**WING "A"**

Administration wing, built in 1992, D.S.A. No. 57157

Permanent	Classrooms	sq. ft.	720	1	rooms
Permanent	Staff Room/Office Area	sq. ft.	3,081	16	rooms
Permanent	Restrooms- Staff	sq. ft.	364	2	rooms
Permanent	Restrooms- Boys	sq. ft.	64	1	rooms
Permanent	Restrooms- Girls	sq. ft.	64	1	rooms
Permanent	Nurse Room	sq. ft.	176	1	rooms
Permanent	Staff Lounge/Kitchen	sq. ft.	984	1	rooms
Permanent	Lounge	sq. ft.	198	1	rooms
Permanent	Vestibule	sq. ft.	179	1	rooms
Permanent	Elevator /Mechanical Room	sq. ft.	112	1	rooms
Permanent	Stairway	sq. ft.	232	1	
Permanent	Mechanical/Custodial Room	sq. ft.	87	1	rooms
Permanent	Open Corridor/ Walkways	<b>1,573</b> sq. ft.			
Permanent	Roof Area	<b>8,382</b> sq. ft.			
	<b>TOTAL Building</b>	<b>sq. ft.</b>	<b>6,261</b>		

## WING "B"

Classroom B1 - B4, Built in 1992, D.S.A. No. 57157

Permanent	Classrooms	sq. ft.	5,340	4	rooms
Permanent	Restroom- Staff	sq. ft.	54	1	rooms
Permanent	Work Prep. Room	sq. ft.	431	2	rooms
Permanent	Mechanical/Custodial Room	sq. ft.	573	6	rooms
Permanent	Cover Corridor/Walkways	400	sq. ft.		
Permanent	Roof Area	7,272	sq. ft.		
	<b>TOTAL Building</b>	<b>sq. ft.</b>	<b>6,398</b>		

## WING "C"

Classroom C1 - C6 Built in 1992, D.S.A. No.57157

Permanent	Classroom	sq. ft.	5,760	6	rooms
Permanent	Staff Room/Office Area	sq. ft.	140	1	rooms
Permanent	Restrooms- Staff	sq. ft.	58	1	rooms
Permanent	Mechanical/Custodial Room	sq. ft.	22	1	rooms
Permanent	Storage	sq. ft.	80	1	rooms
Permanent	Covered Corridors/Walkways	620	sq. ft.		
Permanent	Roof Area	6,500	sq. ft.		
	<b>TOTAL Building</b>	<b>sq. ft.</b>	<b>6,060</b>		

## WING "D"

Classroom D1 - D6, built in 1992, D.S.A. No. 57157

Permanent	Classrooms	sq. ft.	2,880	3	rooms
Permanent	Staff Room/Office Area	sq. ft.	140	1	rooms
Permanent	Restrooms- Staff	sq. ft.	58	1	rooms
Permanent	Mechanical/Custodial Room	sq. ft.	22	1	rooms
Permanent	Storage	sq. ft.	80	1	rooms
Permanent	Covered Corridors/Walkways	508	sq. ft.		
Permanent	Roof Area	6,500	sq. ft.		
	<b>TOTAL Building</b>	<b>sq. ft.</b>	<b>3,180</b>		

## WING "E"

Classroom E12 - E13 & Library, built in 1997, D.S.A. No. 59843

Permanent	Classrooms	sq. ft.	1,110	1	rooms
Permanent	Library	sq. ft.	3,823	1	rooms
Permanent	Conference	sq. ft.	94	1	rooms
Permanent	Staff Room/Office Area	sq. ft.	133	1	rooms
Permanent	Restrooms- Staff	sq. ft.	36	1	rooms
Permanent	Restrooms- Boys	sq. ft.	317	1	rooms
Permanent	Restrooms- Girls	sq. ft.	346	1	rooms
Permanent	Storage/Book Room	sq. ft.	546	1	rooms
Permanent	Mechanical/Custodial Room	sq. ft.	151	2	rooms
Permanent	Covered Corridors/Walkways	444	sq. ft.		
Permanent	Roof Area	7,933	sq. ft.		
	<b>TOTAL Building</b>	<b>sq. ft.</b>	<b>6,556</b>		

## **WING "G"**

Classroom G1 - G5, built in 1997, D.S.A. No. 59843

Permanent	Classrooms	sq. ft.	7,895	5	rooms
Permanent	Staff Room/Office Area	sq. ft.	54	1	rooms
Permanent	Restroom- Boys	sq. ft.	129	1	rooms
Permanent	Restroom- Girls	sq. ft.	129	1	rooms
Permanent	Closet	sq. ft.	49	1	rooms
Permanent	Mechanical/Custodial Room	sq. ft.	605	3	rooms
Permanent	Storage	sq. ft.	54	1	rooms
Permanent	Covered Corridors/Walkways	1,968	sq. ft.		
Permanent	Roof Area	9,128	sq. ft.		
	<b>TOTAL Building</b>	<b>sq. ft.</b>	<b>8,915</b>		

## **Multi-Purpose Room (MPR)**

Gymnasium, built in 1992, D.S.A. No. 57157

Permanent	Classrooms	sq. ft.	3,897	3	rooms
Permanent	Multi-Purpose Room	sq. ft.	6,600	1	rooms
Permanent	Kitchen & Storage	sq. ft.	309	1	rooms
Permanent	Food Serving Area	sq. ft.	576	1	
Permanent	Staff Room/Office Area	sq. ft.	437	3	rooms
Permanent	Restrooms- Staff	sq. ft.	483	4	rooms
Permanent	Restrooms- Boys	sq. ft.	161	1	rooms
Permanent	Restrooms- Girls	sq. ft.	161	1	rooms
Permanent	Vestibule	sq. ft.	1,343	1	rooms
Permanent	Practice Room	sq. ft.	260	4	rooms
Permanent	Supply/Towel Room	sq. ft.	178	4	rooms
Permanent	Girls Locker Room	sq. ft.	788	1	rooms
Permanent	Girls Shower Room	sq. ft.	256	1	rooms
Permanent	Boys Locker Room	sq. ft.	788	1	rooms
Permanent	Boys Shower Room	sq. ft.	256	1	rooms
Permanent	Dressing Room	sq. ft.	112	2	rooms
Permanent	Mechanical/Custodial Room	sq. ft.	614	5	rooms
Permanent	Storage	sq. ft.	544	1	rooms
Permanent	Covered Corridors/Walkways	445	sq. ft.		
Permanent	Roof Area	18,382	sq. ft.		
	<b>TOTAL Building</b>	<b>sq. ft.</b>	<b>17,763</b>		

## **Restroom Facility Counts for Lakeview**

<b>Type of Restroom</b>	<b>Number of Restrooms</b>	<b>Total Number of Fixtures</b>		
		<b>Toilets</b>	<b>Urinals</b>	<b>Sinks</b>
Staff	7	9	1	8
Girls	4	19		11
Boys	4	11	9	10
Library	1	1		1
Nurse	1	1		1

**Total number of drinking fountains on site = 23**



<b>LAKEVIEW MIDDLE SCHOOL</b> , 2350 East Lake Avenue, Watsonville, CA 95076 Ph: (831) 728-6454 Fax: (831) 728-6480 Principal: Ken Woods Custodian: Micheal Ball															
Dist.#	Rm#	Use	Port/trl	Manufacturer	Date/Use	Size	Sq. Ft.	Dist/Own	FILE #	APP#	Lease #	P.O. #	Serial #	D.S.A.#	OPSC#
14-R601	F-1	CLASSROOM	RELO	MEEHLIES	1998	24'x40'	960	YES	44-37				982973-72	59843 #2	
14-R602	F-2	CLASSROOM	RELO	MEEHLIES	1998	24'x40'	960	YES	44-37				982971-70	59843 #2	
14-R603	F-3	CLASSROOM	RELO	MEEHLIES	1998	24'x40'	960	YES	44-37				982969-68	59843 #2	
14-R604	F-4	CLASSROOM	RELO	MEEHLIES	1998	24'x40'	960	YES	44-37				982967-66	59843 #2	
14-R605	F-5	CLASSROOM	RELO	MEEHLIES	1998	24'x40'	960	YES	44-37				982965-64	59843 #2	
14-R606	F-6	CLASSROOM	RELO	MEEHLIES	1998	24'x40'	960	YES	44-37				982963-62	59843 #2	
14-R	H-3	CLASSROOM	RELO	Mobile Modular	2008	24'x40'	960	NO	44-37		584214		01-550-994 A&B	109421	
14-R	H-4	CLASSROOM	RELO	Mobile Modular	2008	24'x40'	960	NO	44-37		584215		01-565-039 A&B	109421	
14-R	H-5	CLASSROOM	RELO	Mobile Modular	2008	24'x40'	960	NO	44-37		584632		01-820-260 A&B	109421	
14-R600	L1,2 & 3	COMPUTER LABS	RELO	D.M.S.I.	1995	40'x72'	2880	YES	44-37				3410-1-2	63076	
<b>10 UNITS TOTAL</b>				<b>12 CLASSROOM - DSA</b>				<b>11520</b>							

Grey Shaded Area = NON-CONFORMING Buildings

Yellow Shaded Area = Permanent Classroom Units on Concrete Foundation