



Monterey County
Office of Education
Head Start

MHS 1
MHS 2

Restrooms A Wing Library MPR

32
31
30
29
28
33
Staff
34

B Wing
Restrooms C Wing Office

D Wing
Restrooms E Wing

Sill Road

26 27
23
25 24
8F 7F

Hall Road

Hall District Elementary School
300 Sill Road, Watsonville, CA 95076
Aerial Photo Taken 3/8/06

Monterey Co Headstart
Rm. 36
768-6949

Hall District Elementary (PVUSD)

300 Sill Rd. Watsonville, CA 95076

Phone: (831) 728-6371

Fax: (831) 761-6174

Emergency Evacuation

Revised 07/09/10

Upper
Parking
Entry
Gate

Upper
Exit
Gate

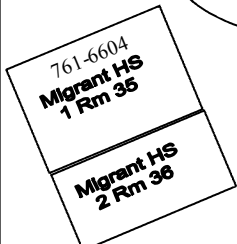
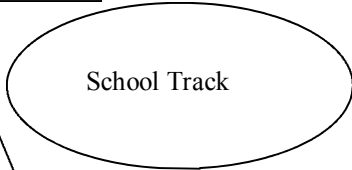

W ← Main Water shut off

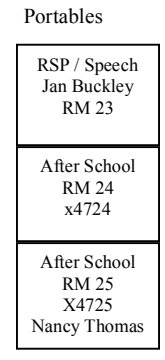
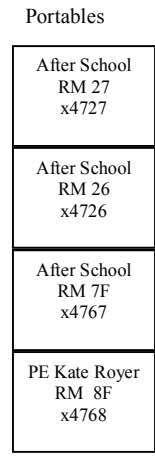
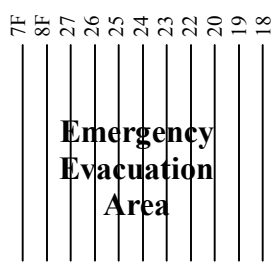
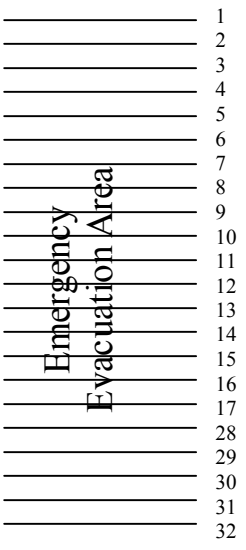
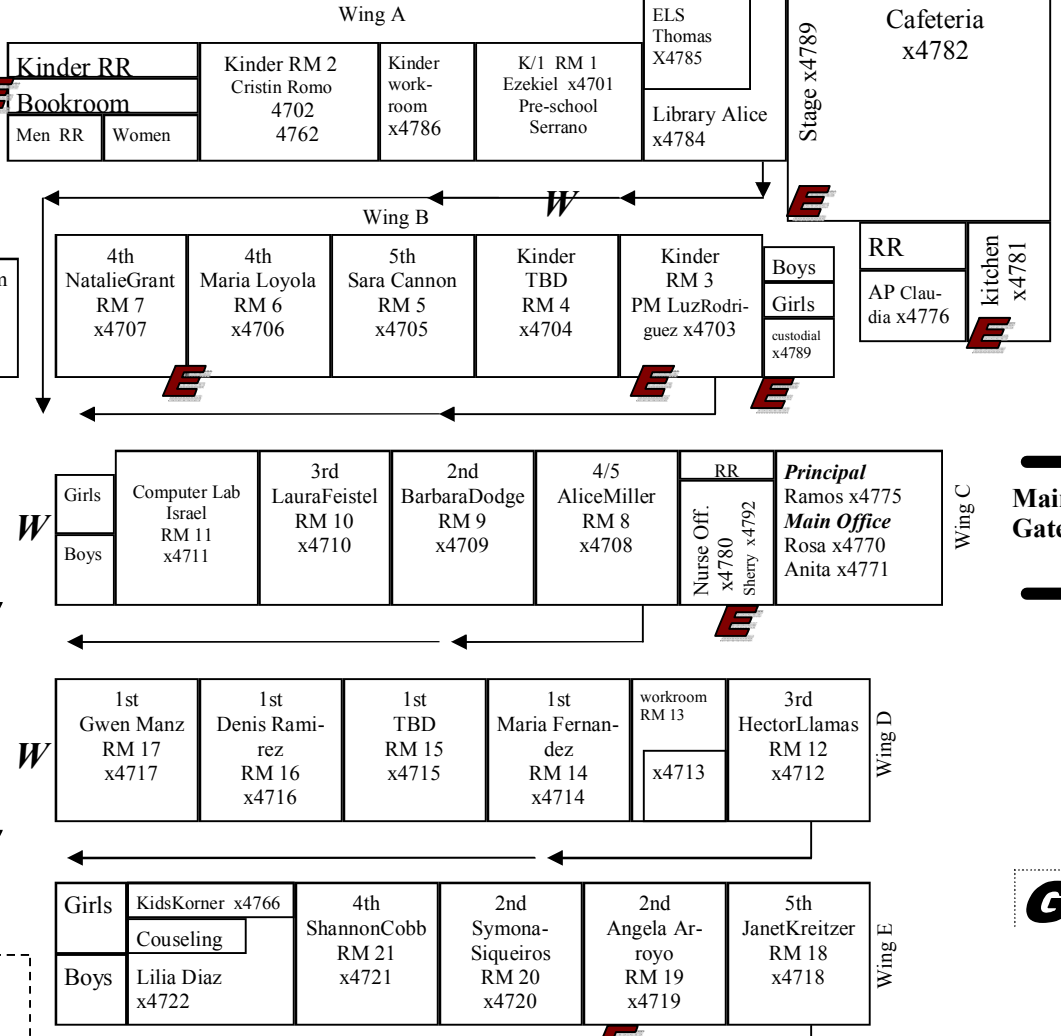
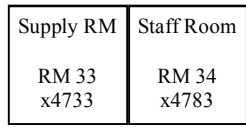
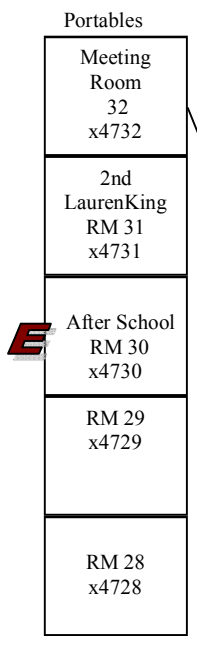

W = Water Shut Off
G = Gas Shut Off
E = Electrical Shutoff

Lower
Parking
Lot

Main
Gate

G

**Hall District Elementary School K-6
& Migrant Head Start**
300 Sill Road, Watsonville, CA 95076
Phone: (831) 728-6371 Fax: (831) 761-6174

APN No. 412-073-004
7.00 Total /Usable Acreage- 2 Total Un-Usable Acreage
Updated 3/2011

Gross Sq. Ft. site use summary

| | | | | | |
|-------------|--|----------------|---------------|----|------------|
| Permanent | Classrooms | sq. ft. | 18,918 | 19 | rooms |
| Relocatable | Classrooms | sq. ft. | 11,040 | 13 | rooms |
| Relocatable | Office/Staff Area | sq. ft. | 960 | 1 | rooms |
| Relocatable | MCOEHS - Pre-School 1,920 | sq. ft. | | 1 | rooms |
| Relocatable | Migrant Head Start 2,400 | sq. ft. | | 2 | rooms |
| Permanent | Staff Area | sq. ft. | 2,495 | 5 | rooms |
| Permanent | Library | sq. ft. | 975 | 1 | rooms |
| Permanent | Restroom-Staff | sq. ft. | 264 | 4 | rooms |
| Permanent | Restroom-Student | sq. ft. | 1,402 | 7 | rooms |
| Permanent | Multi-Purpose Room | sq. ft. | 2,390 | 1 | rooms |
| Permanent | Kitchen | sq. ft. | 1,071 | 1 | rooms |
| Permanent | Storage/Book Room | sq. ft. | 152 | 1 | rooms |
| Permanent | Mechanical/Custodial Room | sq. ft. | 123 | 1 | rooms |
| Permanent | Computer Lab(s) | sq. ft. | | 1 | rooms |
| Permanent | Science Lab(s) | sq. ft. | | 0 | rooms |
| Permanent | Total Teaching Stations | sq. ft. | | 32 | rooms |
| Permanent | Covered Corridor/ Walkways 5,766 | sq. ft. | | | |
| | A.C. Play Area 37,629 | sq. ft. | | | |
| | A.C. Total Road & Parking Area 47,433 | sq. ft. | | 49 | spaces |
| | A.C. Bus Lane Areas 4,004 | sq. ft. | | | |
| | Play Box Structure 9,209 | sq. ft. | | 9 | structures |
| | Storage Shed 130 | sq. ft. | | | |
| | Cargo Container 640 | sq. ft. | | | |
| Permanent | Roof Area 39,099 | sq. ft. | | | |
| Relocatable | Roof Area 18,928 | sq. ft. | | | |
| | | | | | |
| | | | | | |
| | TOTAL Building | sq. ft. | 39,790 | | |
| | | | | | |

WING "A"

Multi-Purpose Room, Library & Classrooms, built in 1961, D.S.A. No. 21174

| | | | | | |
|-----------|-------------------------------|----------------|--------------|---|-------|
| Permanent | Classroom | sq. ft. | 1,338 | 2 | rooms |
| Permanent | Library | sq. ft. | 1,200 | 1 | rooms |
| Permanent | Multi-Purpose Room | sq. ft. | 2,390 | 1 | rooms |
| Permanent | Kitchen | sq. ft. | 1,071 | 1 | rooms |
| Permanent | Covered Walkways 1,278 | sq. ft. | | | |
| Permanent | Roof Area 6,946 | sq. ft. | | | |
| | | | | | |
| | | | | | |
| | TOTAL Building | sq. ft. | 5,999 | | |
| | | | | | |

WING "A"

Kindergarden, built in 1990, D.S.A. No. 54059

| | | | | | |
|-----------|------------------------|----------------|--------------|---|-------|
| Permanent | Classroom | sq. ft. | 1,230 | 1 | rooms |
| Permanent | Staff Room/Office Area | sq. ft. | 440 | 1 | rooms |
| Permanent | Restrooms- Staff | sq. ft. | 114 | 1 | rooms |
| Permanent | Restrooms-Boys/Girls | sq. ft. | 152 | 1 | rooms |
| Permanent | Storage | sq. ft. | 152 | 1 | rooms |
| Permanent | Covered Walkways | 128 | sq. ft. | | |
| Permanent | Roof Area | 3,952 | sq. ft. | | |
| | | | | | |
| | TOTAL Building | sq. ft. | 2,088 | | |
| | | | | | |

WING "B"

Classroom # 3 -7, built in 1961, D.S.A. No. 21174

| | | | | | |
|-----------|---------------------------|----------------|--------------|---|-------|
| Permanent | Classrooms | sq. ft. | 4,858 | 5 | rooms |
| Permanent | Restroom-Boys | sq. ft. | 160 | 1 | rooms |
| Permanent | Restroom-Girls | sq. ft. | 160 | 1 | rooms |
| Permanent | Mechanical/Custodial Room | sq. ft. | 123 | 1 | rooms |
| Permanent | Covered Walkways | 782 | sq. ft. | | |
| Permanent | Roof Area | 5,508 | sq. ft. | | |
| | | | | | |
| | TOTAL Building | sq. ft. | 5,301 | | |
| | | | | | |

WING "C"

Administration Wing & Classrooms 8-11 , built in 1961, D.S.A. No. 21174

| | | | | | |
|-----------|------------------------|----------------|--------------|---|-------|
| Permanent | Classrooms | sq. ft. | 2,970 | 3 | rooms |
| Permanent | Classrooms | sq. ft. | 585 | 1 | rooms |
| Permanent | Staff Room/Office Area | sq. ft. | 975 | 3 | rooms |
| Permanent | Restroom- Staff | sq. ft. | 50 | 3 | rooms |
| Permanent | Restroom- Boys | sq. ft. | 195 | 1 | rooms |
| Permanent | Restroom-Girls | sq. ft. | 195 | 1 | rooms |
| Permanent | Covered Walkways | 782 | sq. ft. | | |
| Permanent | Roof Area- | 5,758 | sq. ft. | | |
| | | | | | |
| | TOTAL Building | sq. ft. | 4,970 | | |
| | | | | | |

WING "D"

Classroom #12-17, built in 1961, D.S.A. No.21174

| | | | | | |
|-----------|-----------------------------|----------------|--------------|---|-------|
| Permanent | Classroom | sq. ft. | 5,058 | 5 | rooms |
| Permanent | Work Room | sq. ft. | 912 | 1 | rooms |
| Permanent | Covered Walkways 912 | sq. ft. | | | |
| Permanent | Roof Area 6,775 | sq. ft. | | | |
| | | | | | |
| | TOTAL Building | sq. ft. | 5,970 | | |
| | | | | | |

WING "E"

Classroom #17-20 & RSP Room, built in 1962, D.S.A. No.21768

| | | | | | |
|-----------|-------------------------------|----------------|--------------|---|-------|
| Permanent | Classrooms | sq. ft. | 3,854 | 3 | rooms |
| Permanent | RSP Room | sq. ft. | 450 | 1 | rooms |
| Permanent | Restrooms-Boys | sq. ft. | 234 | 1 | rooms |
| Permanent | Restrooms-Girls | sq. ft. | 306 | 1 | rooms |
| Permanent | Covered Walkways 1,213 | sq. ft. | | | |
| Permanent | Roof Area 5,160 | sq. ft. | | | |
| | | | | | |
| | TOTAL Building | sq. ft. | 4,844 | | |
| | | | | | |

Migrant Head Start Center

| | | | | | |
|-------------|-------------------------------|----------------|--------------|---|-------|
| Relocatable | Migrant Head Start Classrooms | sq. ft. | 2,400 | 2 | rooms |
| Relocatable | Roof Area 2,820 | sq. ft. | | | |
| | | | | | |
| | TOTAL Building | sq. ft. | 2,400 | | |
| | | | | | |

Restroom Facility Counts for Hall District

| Type of Restroom | Number of Restrooms | Total Number of Fixtures | | |
|-------------------------|----------------------------|---------------------------------|----------------|--------------|
| | | Toilets | Urinals | Sinks |
| Staff | 4 | 4 | | 4 |
| Girls | 3 | 10 | | 7 |
| Boys | 3 | 5 | 9 | 7 |
| Kinders | 1 | 3 | | 2 |
| Nurse | 1 | 1 | | 1 |

Total number of drinking fountains on site = 32

| HALL DISTRICT ELEMENTARY SCHOOL, 300 Sill Road, Watsonville, CA 95076 Ph: (831) 728-6371 Fax: (831) 761-6174 Principal: Guillermo Ramos Custodian: Mark Ellis | | | | | | | | | | | | | | | |
|--|------------|------------------------------------|-----------------|--------------------------------|---|-------------|----------------|-----------------|---------------|-------------|----------------|---------------|-------------------|----------------|--------------|
| Dist.# | Rm# | Use | Port/tri | Manufacturer | Date/Use | Size | Sq. Ft. | Dist/Own | FILE # | APP# | Lease # | P.O. # | Serial # | D.S.A.# | OPSC# |
| 37-R234 | 23 | RSP-SPEECH | RELO | DOUPNIK | 6/3/86 | 24'x40' | 960 | YES | 44-37 | 25-69799-82 | | | 1133 | 47020 | 26196 |
| 37-R235 | 24 & 25 | 1st - GRADE | RELO | MODTECH | 8/18/97 | 36'x40' | 1440 | YES | 44-37 | | | | 24614-6 | 67650 | |
| 37-R239 | 26 & 27 | 1st - GRADE | RELO | MODTECH | 8/18/97 | 36'x40' | 1440 | YES | 44-37 | | | | 24617-9 | 67650 | |
| 37-R230 | 28 | 3rd- GRADE | RELO | MODTECH | 10/1/98 | 24'x40' | 960 | NO | 44-37 | MMMC | 122549 | C11142 | 37067-8 | 101060 | |
| 37-R229 | 29 | 2nd - GRADE | RELO | MODTECH | 1997 | 24'x40' | 960 | YES | 43-47 | | | | 31975-6 | 100021 | |
| 37-R228 | 30 | 5th- GRADE | RELO | SPECTRUM | 9/2/87 | 24'x40' | 960 | YES | 44-37 | 25/69799-16 | | | 1056 | 48239 | 26940 |
| 37-R227 | 31 | 2nd-GRADE EO | RELO | AMER. MOD. | 9/19/90 | 24'x40' | 960 | YES | 43-47 | | | | 90-100-12-A | 53764 | 29752 |
| 37-R226 | 32 | COMPUTER RM. | RELO | AMER. MOD. | 9/19/90 | 24'x40' | 960 | YES | 44-37 | | | | 90-100-13-A | 53764 | 29753 |
| 37-R225 | 33 | 3rd- GRADE | RELO | AMER. MOD. | 9/19/90 | 24'x40' | 960 | YES | 44-37 | | | | 90-100-11-A/B | 53764 | 29751 |
| 37-R231 | 34 | STAFF ROOM | RELO | MODULUX | 1969 | 30'x32' | 960 | YES | | | | | | | |
| 37-R236 | F7&F8 | READING | RELO | MODTECH | 9/1/00 | 36'x40' | 1440 | NO | 44-37 | | 121950 | | 24620-2 | 104095 | |
| 37-R244 | MCOEHS | PRE-SCHOOL | RELO | MODTECH | 2003 | 24'x80' | 1920 | NO | 44-37 | | | | | 105154 | |
| 37-R242 | MHS-1 | CHILD CARE | RELO | AMER. MOD. | 1994 | 36'x40' | 1440 | NO | 44-37 | | | | 94-R178-008-A/B/C | 62388 | |
| 37-R243 | MHS-2 | CHILD CARE | RELO | AMER. MOD. | 1994 | 24'x40' | 960 | NO | 44-37 | | | | 94-R178-009-A/B | 62388 | |
| 14 UNITS TOTAL | | 13 CLASSROOMS-DSA | | 1 MCOE HEAD START - DSA | | | 16320 | | | | | | | | |
| | | 1 STAFF ROOM NON-CONFORMING | | | 2 MIGRANT CHILD CARE CENTERS - DSA | | | | | | | | | | |

Grey Shaded Area = NON-CONFORMING Buildings

Yellow Shaded Area = Permanent Classroom Units on Concrete Foundation