



Freedom Elementary School

25 Holly Drive, Freedom CA 95019

Aerial Photo Taken 4/6/09

FREEDOM ELEMENTARY SCHOOL

25 HOLLY DRIVE
FREEDOM, CA 95019

Site Map and Evacuation Routes

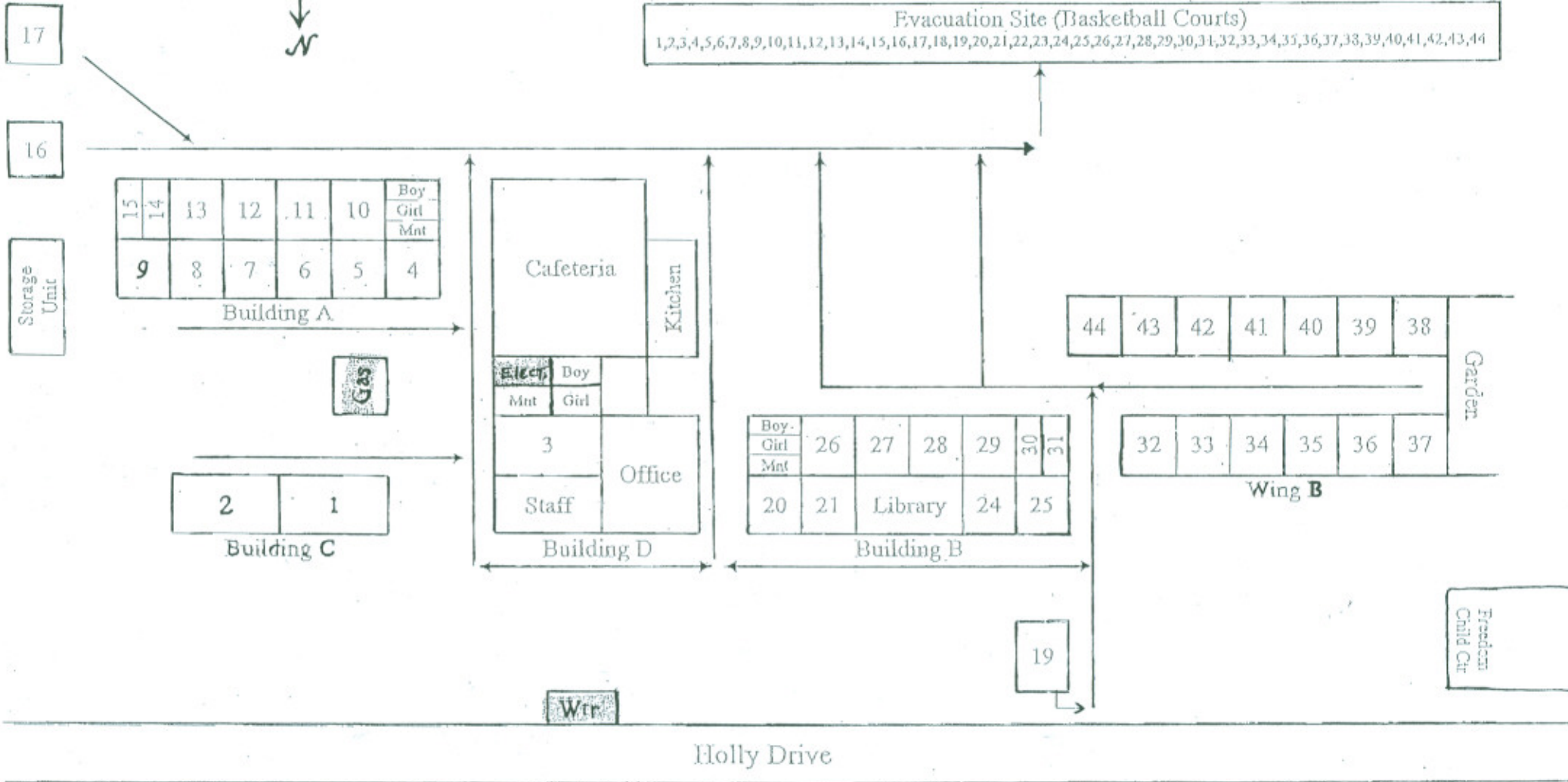

Freedom Elementary School K-5
Freedom Child Care & Migrant Head Start
 25 Holly Drive, Watsonville, CA 95076
 Phone: (831) 728-6260 Fax: (831) 761-6196

APN No. 015-191-02
 13.00 Total Usable Acreage 0 Total Unusable Acreage
 Updated 3/2011

Gross Sq. Ft. Site Use Summary

Permanent	Classrooms	sq. ft.	24,390	24	rooms
Relocatable	Classrooms	sq. ft.	10,560	14	rooms
Relocatable	Staff Area/ Childcare/Migrant H.S.	sq. ft.	7,680	8	rooms
Permanent	Staff Area	sq. ft.	3,344	10	rooms
Permanent	Library	sq. ft.	1,979	1	room
Permanent	Restrooms-Staff	sq. ft.	83	2	rooms
Permanent	Restrooms-Student	sq. ft.	1,468	12	rooms
Permanent	Multi-Purpose Room	sq. ft.	3,336	1	rooms
Permanent	Kitchen	sq. ft.	1,462	2	rooms
Permanent	Storage/Book Rooms	sq. ft.	1,521	5	rooms
Permanent	Mechanical / Custodial Rm.	sq. ft.	337	3	rooms
Permanent	Science Lab(s)	sq. ft.		0	rooms
Permanent	Computer Lab(s)	sq. ft.		2	rooms
	Total Teaching Stations	sq. ft.		38	rooms
	Hall	120	sq. ft.		
	A.C. Play Area	11,281	sq. ft.		
	A. C. Total Road & Parking Area	87,690	sq. ft.	50	spaces
	A.C. Bus Lane Areas	7,462	sq. ft.		
	Play Box Structure	15,154	sq. ft.	20	structures
	Life Lab Areas	19,072	sq. ft.		
	Cargo Container	328	sq. ft.		
	Storage Sheds	372	sq. ft.	7	
Permanent	Covered Corridor / Walkways	7,319	sq. ft.		
Relocatable	Relo Roofs	23,864	sq. ft.		
Permanent	Roof Area	59,377	sq. ft.		
	TOTAL Building	sq. ft.	56,160		

WING "A"

Classrooms #4-14 Built in 1962, D.S.A. No. 21540

Permanent	Classrooms	sq. ft.	10,436	10	rooms
Permanent	Restrooms / Girls	sq. ft.	186	1	rooms
Permanent	Restrooms / Boys	sq. ft.	186	1	rooms
Permanent	Mechanical/Custodial Room	sq. ft.	124	1	rooms
Permanent	Storage	sq. ft.	816	1	rooms
Permanent	Covered Passage	1,798	sq. ft.		
Permanent	Roof Area	12,683	sq. ft.		
	TOTAL Building	sq. ft.	11,748		

WING "B"

Classroom #20,21,24-29 Built in 1962, D.S.A. No.21540

Permanent	Classrooms	sq. ft.	7,912	8	rooms
Permanent	Migrant Classroom	sq. ft.	544	1	rooms
Permanent	Restroom - Boys	sq. ft.	186	1	rooms
Permanent	Restroom - Girls	sq. ft.	186	1	rooms
Permanent	Mechanical / Custodial Room	sq. ft.	124	1	rooms
Permanent	Storage Room	sq. ft.	320	1	rooms
Permanent	Library	sq. ft.	1,979	1	rooms
Permanent	Special Ed	sq. ft.	496	1	rooms
Permanent	Covered Passage	1,780	sq. ft.		
Permanent	Roof Area	15,740	sq. ft.		
	TOTAL Building	sq. ft.	11,747		

WING "C"

Classroom: Kindergarten Built in 1962, D.S.A. No. 21540

Permanent	Classrooms	sq. ft.	2,597	2	rooms
Permanent	Restroom - Boys	sq. ft.	46	1	rooms
Permanent	Restroom - Girls	sq. ft.	46	1	rooms
Permanent	Storage	sq. ft.	93	1	rooms
Permanent	Corridors/Walkways	1,085	sq. ft.		
Permanent	Roof Area	5,474	sq. ft.		
	TOTAL Building	sq. ft.	2,782		

WING "D"

Administration Wing Built 1962 DSA #21540

Permanent	Classrooms / Special Ed	sq. ft.	782	1	rooms
Permanent	Multipurpose Room	sq. ft.	3,336	1	rooms
Permanent	Staff Room / Office Area	sq. ft.	2,684	7	rooms
Permanent	Restroom - Staff	sq. ft.	63	1	rooms
Permanent	Restroom - Girls	sq. ft.	141	2	rooms
Permanent	Restroom - Boys	sq. ft.	165	2	rooms
Permanent	Mechanical / Custodial Room	sq. ft.	89	1	rooms
Permanent	Lobby	sq. ft.	360	1	rooms
Permanent	Kitchen	sq. ft.	1,294	1	rooms
Permanent	Storage	sq. ft.	183	1	rooms
	Corridor / Open	2,696	sq. ft.		
Permanent	Roof Area	16,110	sq. ft.		
	TOTAL Building	sq. ft.	9,097		

KINDERGARDEN CLASSROOMS

Built 1962 DSA #21540

Permanent	Classrooms	sq. ft.	1,623	3	rooms
Permanent	Staff Room / Office Area	sq. ft.	180	1	rooms
Permanent	Restroom - Staff	sq. ft.	20	1	rooms
Permanent	Restroom - Boys	sq. ft.	163	1	rooms
Permanent	Restroom - Girls	sq. ft.	163	1	rooms
Permanent	Interior Corridor	sq. ft.	120		
Permanent	Storage	sq. ft.	109		
Permanent	Kitchen	sq. ft.	168	1	rooms
Permanent	Roof Area		5,070		
		TOTAL Building	sq. ft.	2,546	

Migrant Head Start

Relocatable	Migrant Head Start Center & Office	sq. ft.	2,400	3	rooms
Relocatable	Roof Area		2,500		
		TOTAL Building	sq. ft.	2,400	

Freedom Childcare Center

Relocatable	Freedom Childcare Center & Offices	sq. ft.	4,320	6	rooms
Relocatable	Roof Area		4,400		
		TOTAL Building	sq. ft.	4,320	

Restroom Facility Counts for Freedom

Type of Restroom	Number of Restrooms	Total Number of Fixtures		
		Toilets	Urinals	Sinks
Staff	4	5	3	5
Girls	2	8		6
Boys	2	4	6	4
Kinders	1	2		1
Special Ed.	1	1		1
Nurse	1	1		1

Total number of drinking fountains on site = 23

FREEDOM ELEMENTARY SCHOOL , 25 Holly Drive, Watsonville, CA 95076, Ph: (831) 728-6260 Fax: (831) 761-6196															Principal: Gloria Pulga		Head Custodian: Jeffery Dias	
Dist.#	Rm#	Use	Port/trl	Manufacturer	Date/Use	Size	Sq. Ft.	Dist/Own	FILE #	APP#	Lease #	P.O. #	Serial #	D.S.A.#	OPSC#			
35-R200	16	2nd- GRADE	RELO	MODTECH	8/18/97	24'x40'	960	NO	44-37	MMMC	121676	101709	24577-78	67650				
35-R207	31	STAFF WORK RM.	RELO	Meehlies	1983	24'x40'	960	YES	44-37									
35-R208	32 & 33	CLASSROOM	RELO	MODTECH	8/18/97	36'x40'	1440	YES	44-37				24604-03	67650				
35-R210	34 & 35	CLASSROOM	RELO	MODTECH	8/18/97	36'x40'	1440	YES	44-37				24607-06	67650				
35-R212	36 & 37	CLASSROOM	RELO	MODTECH	8/18/97	36'x40'	1440	YES	44-37				24610-09	67650				
35-R205	38 & 39	CLASSROOM	RELO	MODTECH	7/1/98	36'x40'	1440	NO	44-37	MMMC	121960	101716	35478-80	100906				
35-R203	40 & 41	CLASSROOM	RELO	MODTECH	1997	36'x40'	1440	NO	44-37	MMMC	121957	46103	32002-4	100021				
35-R201	42 & 43	CLASSROOM	RELO	MODTECH	1989	36'x40'	1440	YES	44-37				31-988	100021				
35-R218	44	CLASSROOM	RELO	MODTECH	6/23/00	24'x40'	960	YES	44-37					103285				
35-R216	MHS-1	MHS	RELO	STEELGUARD	1989	24'x40'	960	NO	44-37				7479-80	51217				
35-R217	MHS-2	MHS	RELO	STEELGUARD	1989	24'x40'	960	NO	44-37				7208-7209	51217				
35-R	MHS-3	MHS-OFFICE	RELO	AMER. MOD.	2002	12'x40'	480	NO	44-37					104597				
35-R724		CHILD CARE CENTER	RELO	STEELGUARD	1983	40'x108'	4320	YES	44-37				1619	107483				
14 UNITS TOTAL		14 CLASSROOMS - DSA		1 MHS OFFICE - DSA			18240											
		2 MIGRANT HEAD STARTS - DSA		1 CHILD CARE CENTER - DSA														
		2 STAFF ROOM / WORK ROOM & RSP SPEECH - NON CONFORMING																

Grey Shaded Area = NON CONFORMING Buildings

Yellow Shaded Area = Permanent Classroom Units on Concrete Foundation