



**Cesar E. Chavez Middle School**  
 440 Arthur Road, Watsonville, CA 95076  
 Aerial Photo Taken 4/26/2003

***Facilities Map  
2010-2011***

**Off Limits  
Area**

**Cesar E. Chavez Middle School**  
440 Arthur Road  
Watsonville, CA  
761-7699

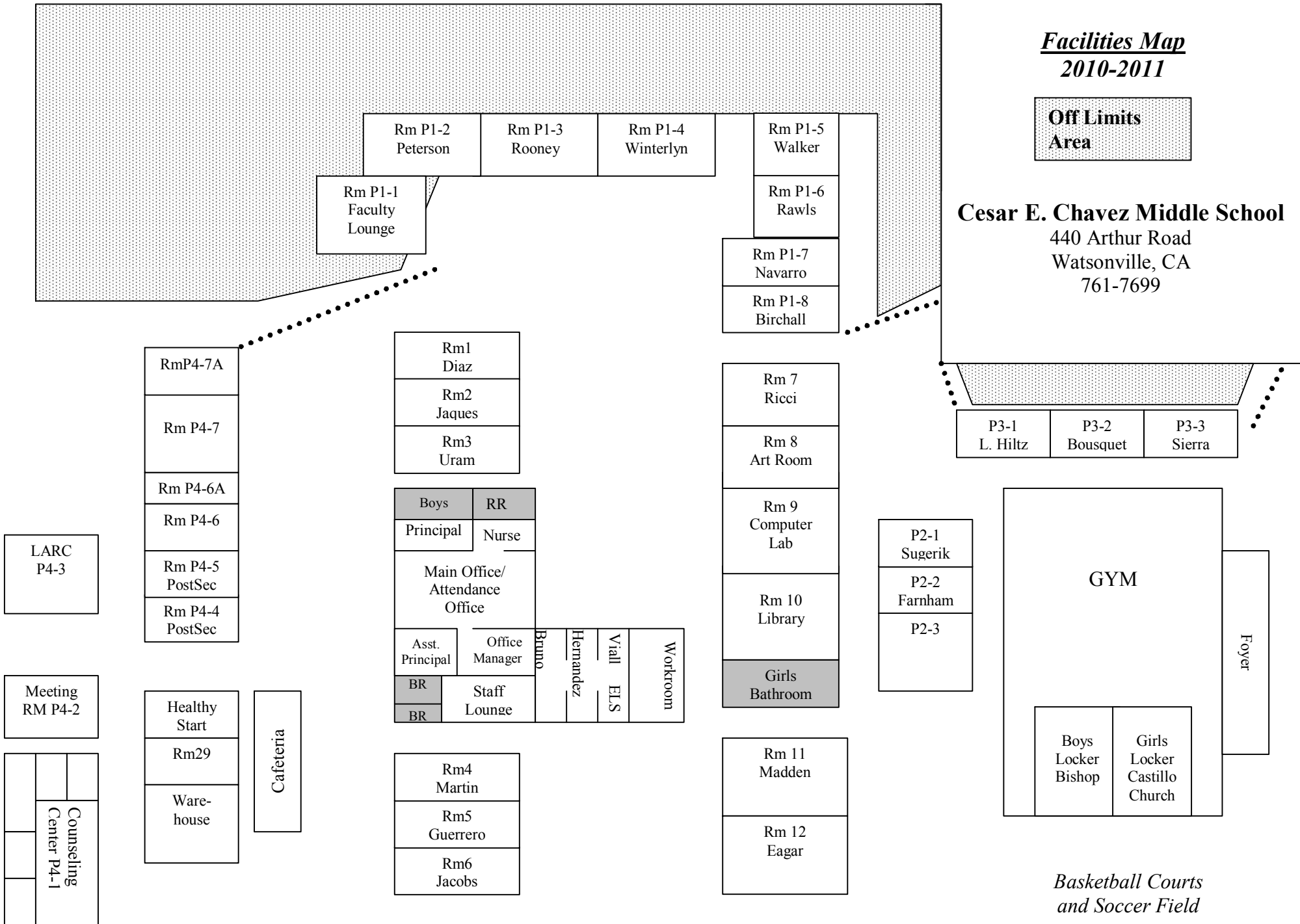

Counselors: Flores, Migrant Counselor

*Basketball Courts  
and Soccer Field*

# Evacuation Map 2010-2011

## Facilities Map

Off Limits Area

**Cesar E. Chavez Middle School**  
440 Arthur Road  
Watsonville, CA  
761-7699

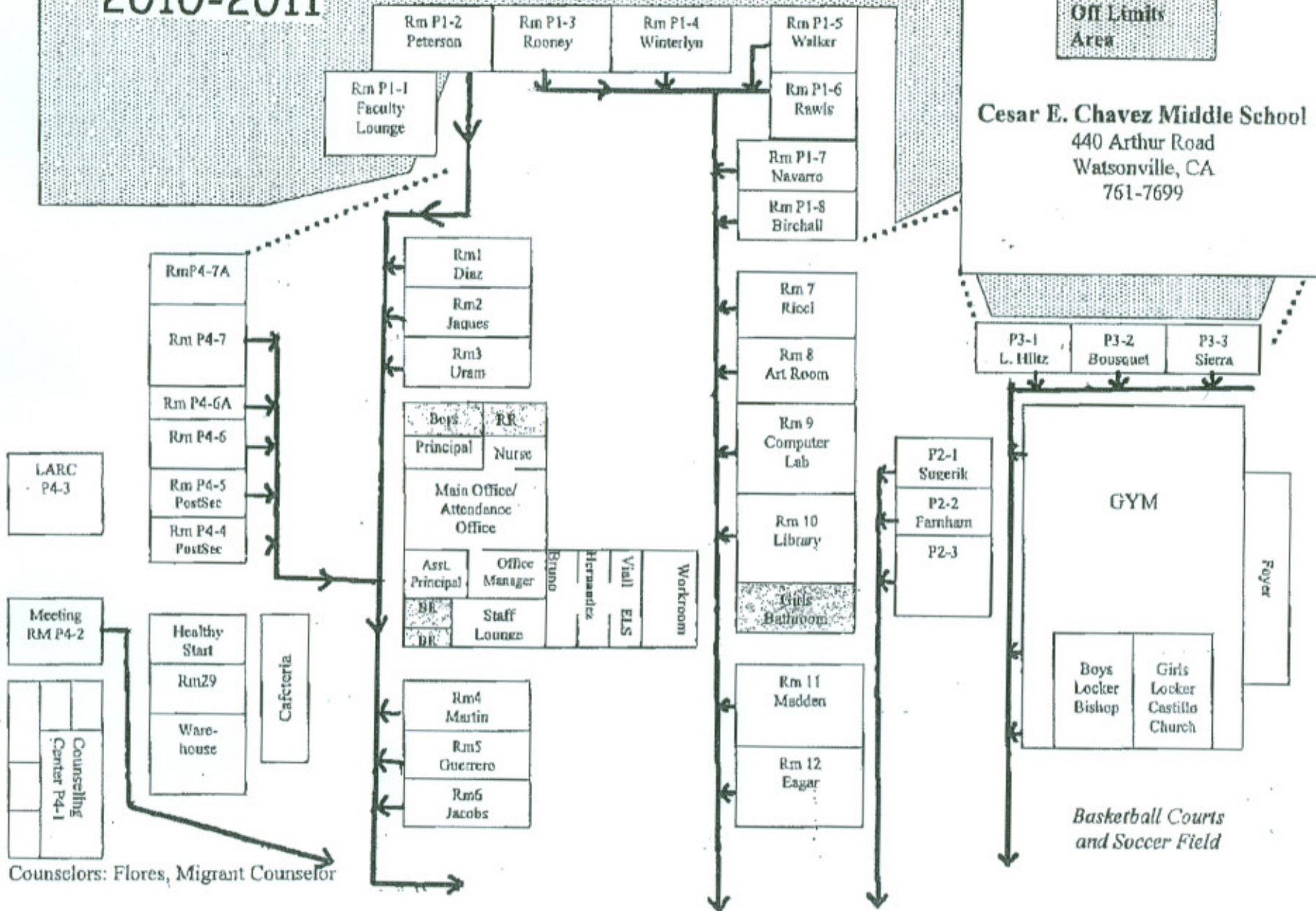

Counselors: Flores, Migrant Counselor

## Cesar E. Chavez Middle School 6-8

440 Arthur Road, Watsonville, CA 95076

Phone: (831) 761-7699 Fax: (831) 728-6477

APN No.016-421-02 03 04

9 Total Usable Acreage 1.38 Total Unusable Acreage

Updated 3/2011

### Gross Sq. Ft. Site Use Summary

Permanent	Classrooms	sq. ft.	14,106	18	rooms
Relocatable	Classrooms	sq. ft.	18,980	13	rooms
Relocatable	Office Area	sq. ft.	2,160	1	rooms
Permanent	Staff Area	sq. ft.	2,586	9	rooms
Permanent	Library	sq. ft.	1,553	1	rooms
Permanent	Computer Lab	sq. ft.	440	1	rooms
Permanent	Restrooms-Staff	sq. ft.	97	3	rooms
Permanent	Restrooms-Student	sq. ft.	2,805	6	rooms
Permanent	Multi-Purpose Room	sq. ft.	2,367	1	rooms
Permanent	Kitchen	sq. ft.	1,171	1	rooms
Permanent	Storage/Book Rooms	sq. ft.	112	1	rooms
Permanent	Mechanical/Custodial Room	sq. ft.	797	5	rooms
Permanent	Gym	sq. ft.	10,972	2	rooms
Permanent	Warehouse	sq. ft.	1,800	1	rooms
Permanent	Halls	sq. ft.	113		
	A.C. Play & Parking Area	<b>57,733</b>	sq. ft.	52	spaces
	A.C. Bus Lane Areas	<b>11,650</b>	sq. ft.		
Permanent	Roof Area	<b>55,106</b>	sq. ft.		
Relocatable	Roof Area	<b>24,558</b>	sq. ft.		
	computer Lab(s)			1	rooms
	Science Lab(s)			0	rooms
	Total Teaching stations			31	
	<b>TOTAL Building</b>	<b>sq. ft.</b>	<b>60,059</b>		

### WING "A"

Administration Wing/12 Classrooms, Built in 1971, D.S.A. No. 34642

Permanent	Classrooms	sq. ft.	13,546	14	rooms
Permanent	Staff Room/Office Area	sq. ft.	1,553	7	rooms
Permanent	Staff Restrooms	sq. ft.	24	1	rooms
Permanent	Restrooms / Girls	sq. ft.	349	2	rooms
Permanent	Restrooms / Boys	sq. ft.	304	2	rooms
Permanent	Mechanical/Custodial Room	sq. ft.	304	1	rooms
Permanent	Library	sq. ft.	1,553	1	rooms
Permanent	Roof Area	<b>20,257</b>	sq. ft.		
	Corridor - closed	<b>1,069</b>	sq. ft.		
	Corridor - open	<b>3,557</b>	sq. ft.		
	Corridor Roof A to B	<b>1,476</b>	sq. ft.		
	Corridor Roof A to B	<b>429</b>	sq. ft.		
	<b>TOTAL Building</b>	<b>sq. ft.</b>	<b>17,633</b>		

## WING "B"

Classroom & GYM Built in 1971, D.S.A. No.34642

Permanent	Restroom - Boys	sq. ft.	1,076	2	rooms
Permanent	Restroom - Girls	sq. ft.	1,076	2	rooms
Permanent	Mechanical / Custodial Room	sq. ft.	194	3	rooms
Permanent	Gym	sq. ft.	10,972	2	rooms
Permanent	Covered Corridor/Walkways	1,177	sq. ft.		
Permanent	Roof Area	15,032			
	<b>TOTAL Building</b>	<b>sq. ft.</b>	<b>13,318</b>		

## WING "C"

Cafeteria, Built in 1971, D.S.A. No. 34642

Permanent	Multipurpose Room	sq. ft.	2,367	1	rooms
Permanent	Restroom - Staff	sq. ft.	10	1	rooms
Permanent	Kitchen	sq. ft.	1,011	1	rooms
Permanent	Mechanical / Custodial Room	sq. ft.	299	1	rooms
Permanent	Corridor - Open	48	sq. ft.		
Permanent	Covered Corridor/Walkways	1,324	sq. ft.		
Permanent	Roof Area	4,537			
	<b>TOTAL Building</b>	<b>sq. ft.</b>	<b>3,687</b>		

## Learning Assesment Resource Center (LARC)

Relocatable	L.A.R.C.	sq. ft.	960	1	rooms
Relocatable	Roof Area	1,128	sq. ft.		
	<b>TOTAL Building</b>	<b>sq. ft.</b>	<b>960</b>		

## Staff/Offices

Relocatable	Staff/Office	sq. ft.	2,160	1	rooms
Relocatable	Roof Area	2,160	sq. ft.		
	<b>TOTAL Building</b>	<b>sq. ft.</b>	<b>2,160</b>		

## Special Education

Relocatable	Special Education Classroom	sq. ft.	2,880	3	rooms
Relocatable	Roof Area	3,560	sq. ft.		
	<b>TOTAL Building</b>	<b>sq. ft.</b>	<b>2,880</b>		

## Children Resource Center/Curriculum Warehouse

Permanent	Rooms 1,2,3 & 4, Health Program	sq. ft.	560	4	rooms
Permanent	Staff Room/Office Area	sq. ft.	1,033	5	rooms
Permanent	Computer Room	sq. ft.	see above	1	rooms
Permanent	Restroom - Staff	sq. ft.	63	1	rooms
Permanent	Staff Kitchen	sq. ft.	160	1	rooms
Permanent	Warehouse	sq. ft.	1,800	1	rooms
Permanent	Storage	sq. ft.	112	3	rooms
Permanent	Halls	sq. ft.	113		
Permanent	Roof Area	6,200	sq. ft.		
		<b>TOTAL Building</b>	<b>sq. ft.</b>	<b>3,841</b>	

## **Restroom Facility Counts for Cesar E. Chavez**

<b>Type of Restroom</b>	<b>Number of Restrooms</b>	<b>Total Number of Fixtures</b>		
		<b>Toilets</b>	<b>Urinals</b>	<b>Sinks</b>
Staff	4	4		4
Girls	2	8		6
Boys	2	8	6	7
Nurse	1	1		1

**Total number of drinking fountains on site = 26**

<b>CESAR E. CHAVEZ MIDDLE SCHOOL</b> , 440 Arthur Road, Watsonville, CA 95076, Ph: (831) 761-7699 Fax: (831) 728-6477 Principal: Ian MacGregor Custodian: Fidel Hernandez															
Dist.#	Rm#	Use	Port/trl	Manufacturer	Date/Use	Size	Sq. Ft.	Dist/Own	FILE #	APP#	Lease #	P.O. #	Serial #	D.S.A.#	OPSC#
31-R137	P1- 1	CLASSROOM	RELO.	TELLUS	1983	24'x40'	960	YES	44-37					45233	
31-R134	P1- 2,3,4	CLASSROOM	RELO.	STEELGUARD	1981	72'x40'	2880	YES	44-37					44545	
31-R143	P1- 5,6	CLASSROOM	RELO.	MODTECH	10/1/98	24'x60'	1440	NO	44-37	MMMC	122546	C11143	36170-71	100907	
31-R132	P1- 7,8	CLASSROOM	RELO.	STEELGUARD	1981	48'x40'	1920	YES	44-37					44545	
31-R128	P2-1	CLASSROOM	RELO.	MODTECH	1997	24'x40'	960	YES	44-37				24562-61	67446	
31-R127	P2-2	CLASSROOM	RELO.	DOUPNIK	4/24/86	24'x40'	960	YES	44-37	25/69799-01			1009	47020	26121
31-R126	P2-3	CLASSROOM	RELO.	DOUPNIK	4/24/86	24'x40'	960	YES	44-37	25/69799-01			1010	47020	26124
31-R129	P3-1	CLASSROOM	RELO.	MODTECH	1997	24'x40'	960	YES	44-37				24560-59	67446	
31-R130	P3-2	CLASSROOM	RELO.	MODTECH	1997	24'x40'	960	NO	44-37	MMMC	121671	101709	24563-64	67446	
31-R131	P3-3	CLASSROOM	RELO.	MODTECH	1997	24'x40'	960	NO	44-37	MMMC	121672	101709	24565-66	67446	
31-R140	LARK	EIP - APS	RELO.	MODTECH	2000	24'x40'	960	YES	44-37			101516	48013	103284	
31-R142	Office	STAFF OFFICE	RELO.	STEELGUARD	1980	36'x60'	2160	YES							
31-R138	30, 31, 32	SPECIAL ED.	RELO.	MODULUX	N/A	32'X90'	2880	YES							
31-R139	33 & 34	CLASSROOMS	RELO.	MODULUX	N/A	32'X40'	1280	YES							
31-R141	35	CLASSROOM	RELO.	STEELGUARD	1978	25'x36'	900	YES							
<b>15 UNITS TOTAL</b>		<b>14 CLASSROOMS-DSA</b>					<b>21140</b>								
		<b>1 STAFF ROOM - DSA</b>		<b>4 UNITS NON- CONFORMING</b>											

Grey Shaded Area = NON-CONFORMING Buildings

Yellow Shaded Area = Permanent Classroom Units on Concrete Foundation